



# WASHER-DRYER

## USER'S MANUAL

GWD 59400 CW

EN

[www.grundig.com](http://www.grundig.com)

**GRUNDIG**

Document Number 2820525156/24-11-17.(16:08)

# Please read this manual first!

Dear Customer,

Thank you for preferring a Grundig product. We hope that you get the best results from your product which has been manufactured with high quality and state-of-the-art technology. Therefore, please read this entire user manual and all other accompanying documents carefully before using the product and keep it as a reference for future use. If you handover the product to someone else, give the user manual as well. Follow all warnings and information in the user manual.

Please note that this Operating Manual may be applicable for several other models. Differences between models will be identified in the manual.

## Explanation of symbols

Throughout this Operation Manual the following symbols are used:



### DANGER

- **Warning for electric shock.**



### DANGER

- **Product is heavy**



### CAUTION

- Warning for hazardous situations with regard to life and property.



### CAUTION

- Precautions to be taken.



### NOTE

- *Important information or useful hints about usage.*



- *Please read the user manual.*



- *Packaging materials of the product are manufactured from recyclable materials in accordance with our National Environment Regulations.*
- *Do not dispose of the packaging materials together with the domestic or other wastes. Take them to the packaging material collection points designated by the local authorities.*



APPAREL CARE

“The wool wash cycle of this machine has been approved by The Woolmark Company for the washing of machine washable wool products provided that the products are washed according to the instructions on the garment label and those issued by the manufacturer of this washing machine. M13996.”

“In UK, Eire, Hong Kong and India the Woolmark trade mark is a Certification trade mark.”

<b>Important instructions for safety and environment</b>	<b>6</b>
General safety .....	6
Electrical safety .....	7
Product safety.....	8
Warnings for dryer .....	9
Intended use.....	11
Children's safety .....	11
Compliance with WEEE Directive.....	12
Package information.....	12
<b>Your washer-dryer</b>	<b>13</b>
Overview.....	13
Package Contents .....	14
Technical specifications .....	15
<b>Installation</b>	<b>16</b>
Appropriate installation location .....	16
Removing packaging reinforcement.....	17
Removing the transportation locks .....	17
Flush usage with the bench .....	18
Connecting water supply .....	19
Connecting to the drain.....	20
Adjusting the feet .....	21
Electrical connection .....	22
Transportation of the product.....	23
<b>Preparation</b>	<b>24</b>
Sorting the laundry .....	24
Preparing laundry for washing .....	25
Things to be done for energy saving .....	26
First use .....	26
Correct load capacity .....	27
Loading the laundry .....	27
Using detergent and softener .....	28
Detergent drawer .....	28
Detergent, softener and other cleaning agents.....	28
Choosing the detergent type.....	29
Adjusting detergent amount.....	29
Using softeners .....	29
Using liquid detergents.....	29
If the product has a liquid detergent cup .....	29
If the product does not have a liquid detergent cup .....	30

## TABLE OF CONTENTS

Using gel and tablet detergent .....	30
Using starch .....	30
Using bleaches .....	31
Using limescale remover .....	31

### **Operating the product** **32**

Control panel.....	32
Display symbols .....	33
Preparing the machine .....	33
Program selection and tips for washing .....	34
<b>Washing programs</b> .....	<b>35</b>
Cottons .....	35
Synthetics.....	36
WoolProtect.....	36
Cottons Eco .....	37
Delicates .....	37
Hand Wash .....	37
Mini 14' .....	38
AquaPerfect 40°/40' .....	38
Rinse .....	38
Spin + Drain .....	38
Waterproofing .....	39

### **Temperature selection.....** **40**

### **Selecting the spin speed.....** **41**

If you want to spin your laundry after the Rinse Hold function:.....	41
--	----

### **Drying Programmes.....** **42**

Synthetic Dry.....	42
Cotton Dry .....	43

### **Washing and Drying Programmes.....** **44**

6 kg Wash&Dry.....	44
Mini Wash&Dry .....	45
HygieneCare Wash&Dry .....	45
Tips for efficient drying .....	46

### **Programme and consumption table .....** **47**

### **Auxiliary function selection .....** **49**

Prewash .....	50
Extra Rinse.....	50
Silent Mode .....	50
Drying.....	50

### **Drying Steps.....** **50**

Iron dry  .....	50
Wardrobe dry  .....	50
Extra wardrobe dry  .....	50
Delicate drying  .....	50
Time-based drying - minutes.....	51

### **Time display.....** **51**

End Time .....	52
Starting the programme .....	52
Loading door lock.....	53
Changing the selections after programme has started .....	53
Adding laundry after the programme has started:.....	53
Switching the machine to pause mode: .....	53
Changing the programme selection after programme has started: .....	54
Changing the auxiliary function, speed and temperature settings.....	54
<b>Child Lock</b> .....	<b>54</b>
To activate the Child Lock:.....	55
To deactivate the Child Lock:.....	55
<b>Cancelling the programme</b> .....	<b>56</b>
<b>End of programme</b> .....	<b>56</b>
<b>Entering the Settings menu</b> .....	<b>57</b>
Changing the language selection .....	57
Changing the screen brightness setting .....	58
Muting and unmuting the Audible Warning .....	58
Restoring the factory settings .....	58
<b>Memory programme setting</b> .....	<b>59</b>
To store a new favourite programme: .....	59
To select a favourite programme: .....	59
<b>Your machine is equipped with a "Standby Mode"</b> .....	<b>59</b>
<hr/> <b>Maintenance and cleaning</b> .....	<hr/> <b>60</b>
Cleaning the detergent drawer.....	60
Cleaning the loading door and the drum .....	60
Cleaning the air suction filter .....	61
Cleaning the body and control panel .....	62
Cleaning the water intake filters .....	62
Draining remaining water and cleaning the pump filter .....	62
In order to clean the dirty filter and discharge the water: .....	63
To discharge the water:.....	63
<hr/> <b>Troubleshooting</b> .....	<hr/> <b>64</b>

# Important instructions for safety and environment

This section contains safety instructions that will help protect from risk of personal injury or property damage. Failure to follow these instructions shall void any warranty.

## General safety

### CAUTION



- This product can be used by children at and above 8 years old and by persons whose physical, sensory or mental capabilities were not fully developed or who lack experience and knowledge provided that they are supervised or trained on the safe usage of the product and the risks it brings out. Children must not play with the product. Cleaning and maintenance works which can be done by users should not be performed by children unless they are supervised by someone.

### CAUTION



- Never place the product on a carpet-covered floor. Otherwise, lack of airflow beneath the machine will cause electrical parts to overheat. This will cause problems with your product.

### NOTE



- *Always have the repairing procedures carried out by the Authorised Service Agent. Manufacturer shall not be held liable for damages that may arise from procedures carried out by unauthorised persons.*

### DANGER



- **If the product has a failure, it should not be operated unless it is repaired by the Authorised Service Agent. There is the risk of electric shock!**
- **Never wash the product by spreading or pouring water onto it! There is the risk of electric shock!**

### CAUTION



- If the power cable is damaged, it must be replaced by the manufacturer, after-sales service or a similarly qualified person (preferably an electrician) or someone designated by the importer in order to avoid possible risks.

### CAUTION



- Unplug the product when not in use.
- Never touch the plug with wet hands! Never unplug by pulling on the cable, always pull out by grabbing the plug.
- Unplug the product during installation, maintenance, cleaning and repairing procedures.
- Do not make connections via extension cables or multi-plugs.

### NOTE



- *This product is designed to resume operating in the event of powering on after a power interruption. If you wish to cancel the programme, see "Cancelling the programme" section.*

## Product safety



### DANGER

- **Never open the loading door or remove the filter while there is still water in the drum. Otherwise, risk of flooding and scalds from hot water will occur.**



### CAUTION

- The water supply and draining hoses must be securely fastened and remain undamaged. Otherwise, there is the risk of water leakage.

### NOTE



- *Do not force open the locked loading door. The loading door will be ready to open just a few minutes after the washing cycle is completed. The loading door will not open if the machine is not cooled down enough after the programme. You can ensure a faster cool down of the machine by running a 10-minute drying programme, or wait until it cools down by itself. Do not force the loading door open. The door and the lock mechanism can get damaged.*
- *There should not be any lockable, sliding or hinged door that may prevent the loading door from fully opening in the installation place of this product.*
- *Follow the instructions on the textile tags and on the detergent package.*
- *Only detergents, softeners and supplements suitable for washing machines should be used.*
- *Do not install or leave this product in places where it will be exposed to weather conditions.*
- *Controls should not be tampered with.*



**DANGER**

- Oil-affected items can ignite spontaneously, especially when exposed to heat sources such as in a tumble dryer. The items become warm, causing an oxidation reaction in the oil. Oxidation creates heat. If the heat cannot escape, the items can become hot enough to catch fire. Piling, stacking or storing oil-affected items can prevent heat from escaping and so create a fire hazard.
- If it is unavoidable that fabrics that contain vegetable or cooking oil or have been contaminated by hair care products be placed in a tumble dryer they should first be washed in hot water with extra detergent - this will reduce, but not eliminate, the hazard.
- As the laundry which had been cleaned, washed, soiled or stained with benzene/diesel oil, dry cleaning solvents or other combustible and explosive materials before will emit flammable or explosive vapour, they should not be dried in the machine. This may cause risk of fire.

**Warnings for dryer****DANGER**

- Do not touch the door glass with bare hands after drying. This may cause risk of burn.
- To keep the laundry under a temperature at which they will not be damaged, a cooling step is carried out as the last stage. If you open the loading door before cooling step is completed, you may be exposed to hot vapour. This may cause risk of scalding.
- When drying programmes are interrupted (cancelling the programme or power cut), laundry in the machine may be hot. Be careful.

## CAUTION



- Do not stop the machine before the drying programme is completed. If you have to stop it, take out all laundry promptly and spread them on somewhere appropriate where they can cool down.
- Do not dry tulle curtains, rugs and blankets in the machine.
- Your product is suitable to operate under ambient temperatures between 0°C and +35°C.
- Ambient temperatures between 15°C and +25°C are the ideal operating temperatures for your product.
- Pay care that pets do not enter into the product. Check inside of the product prior to use.
- Do not perform drying by overloading the machine. Follow the maximum load amounts specified for drying.

## CAUTION



- Drying should not be performed on leather garments or garments containing leather (e.g. leather jeans tags, etc.). Leather piece may colour.
- Turn off the machine in failures that cannot be eliminated by applying the information given in the safety instructions, then unplug it and call the Authorised Service Agent.
- It is possible only to wash the laundry or only to dry the laundry or perform both washing and drying in the washer-dryer. Machine should not be used for drying for a long time only with damp load. If the machine is used only for drying, any of the short washing programmes should be run without putting in laundry after every 15 cycles.
- Control all clothes before loading the machine to make sure that no belongings such as lighter, coins, metal pieces, pins, etc have been left in the pockets or among them.
- Underwear with metal supports should not be dried in the machine. Metal supports may get loose and broken during drying process, thus cause damage on the cloth.
- Do not dry voluminous laundry such as duvet and alike in the machine. Otherwise, your laundry may get damaged.

## NOTE



- *Do not dry the unwashed laundry in the machine.*
- *Do not use fabric softeners or antistatic products in the machine unless these are recommended by their manufacturers.*
- *Fabric softeners and products alike should be used in accordance with the instructions of their producers.*
- *Do not dry delicate clothes such as silk, woollens, etc. in the machine. Otherwise, woollens clothes may shrink and become smaller and other delicate clothes may get damaged.*
- *Check the symbols on the product label on the garment prior to Drying and Washing processes.*

## Intended use

### NOTE



- *This product has been designed for domestic use. It is not suitable for commercial use and it must not be used out of its intended use.*
- *Use the product only for washing, rinsing and drying of textile products that are marked accordingly.*
- *The manufacturer waives any responsibility arisen from incorrect usage or transportation.*
- *The service life of your product is 10 years. During this period, original spare parts will be available to operate the appliance properly.*

## Children's safety

### CAUTION



- Keep children under 3 years of age away from the appliance unless they are supervised.
- Packaging materials are dangerous to children. Keep packaging materials in a safe place away from reach of the children.
- Electrical products are dangerous for the children. Keep children away from the product when it is in use. Do not let them to tamper with the product. Use child lock to prevent children from intervening with the product.
- Do not forget to close the loading door when leaving the room where the product is located.
- Store all detergents and additives in a safe place away from the reach of the children by closing the cover of the detergent container or sealing the detergent package.

## Compliance with WEEE Directive

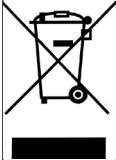

- This product complies with EU WEEE Directive (2012/19/EU). This product bears a classification symbol for waste electrical and electronic equipment (WEEE).
- This product has been manufactured with high quality parts and materials which can be reused and are suitable for recycling. Do not dispose of the waste product with normal domestic and other wastes at the end of its service life. Take it to the collection center for the recycling of electrical and electronic equipment. Please consult your local authorities to learn about these collection centers.
- Compliance with RoHS Directive:
- The product you have purchased complies with EU RoHS Directive (2011/65/EU). It does not contain harmful and prohibited materials specified in the Directive.

## Package information

- Packaging materials of the product are manufactured from recyclable materials in accordance with our National Environment Regulations. Do not dispose of waste package together with domestic or other wastes. Dispose them at package collection points specified by the local authorities.

## Overview

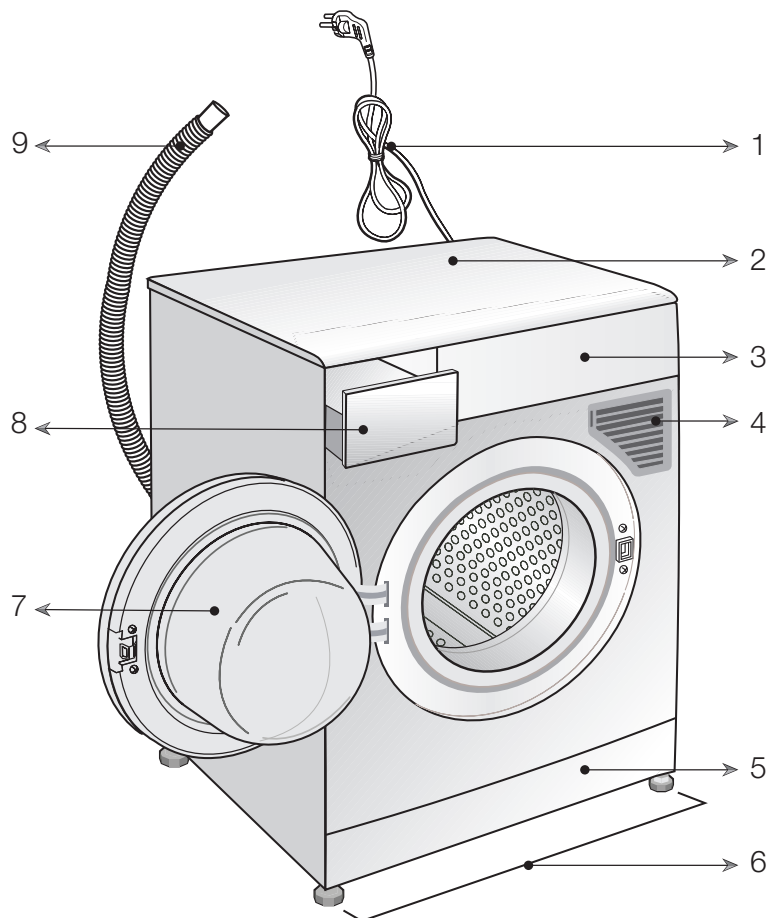

- 1- Power cable
- 2- Top panel
- 3- Control panel
- 4- Air inlet filter
- 5- Draining filter lid
- 6- Adjustable feet
- 7- Loading door
- 8- Detergent drawer
- 9- Drain hose

# Package Contents

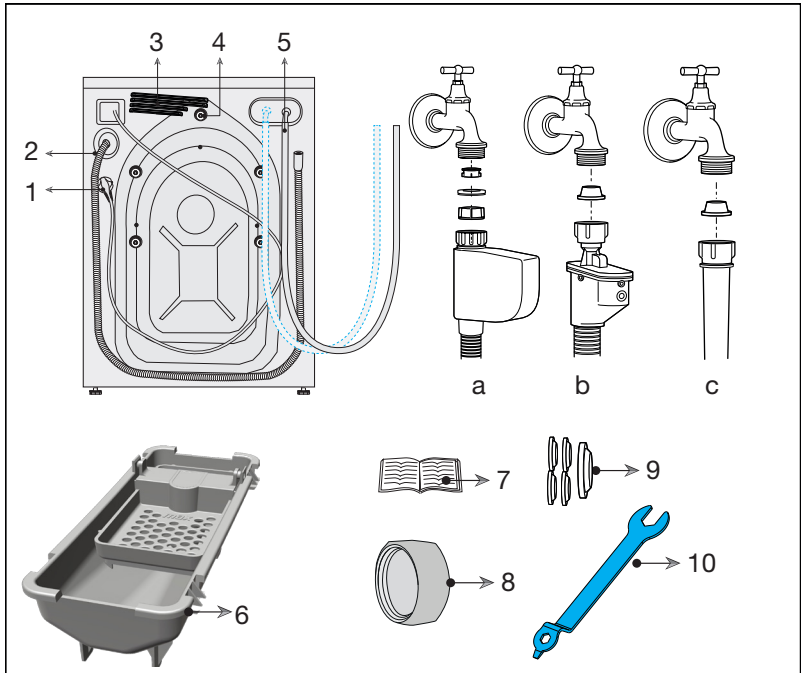

- 1- Power cable
- 2- Drain hose
- 3- Air discharge section
- 4- Transportation safety bolts\*
- 5- Mains water inlet hose (One of the following filter types is used for the mains hose connection.)
  - a- Electronic water shut-off
  - b- Mechanical water shut-off
  - c- Standard
- 6- Liquid detergent container\*\*
- 7- User Manual
- 8- Blind plug\*\*\*
- 9- Plastic plug assembly
- 10- Tool

\* Number of transportation safety bolts may change depending on the model of your machine.

\*\* This may be supplied with the machine depending on the model of your machine.

\*\*\* It is supplied if your machine is equipped with two water inlets at the backside.

## Complying Commission Delegated Regulation (EU) No.96/60/EC/1996

Supplier name or trademark	GRUNDIG
Model name	GWD59400CW
Washer Dryer Energy efficiency class <sup>(1)</sup>	A
Washing Energy efficiency class <sup>(1)</sup>	A
(Washing & Drying) Energy Consumption - full load per cycle (kWh)	6,12
Washing Energy Consumption - full load per cycle (kWh)	1,03
Annual (Washing & Drying) Energy Consumption (kWh) <sup>(2)</sup>	1224
Annual Washing Energy Consumption (kWh) <sup>(2)</sup>	206
Water Consumption (Washing & Drying) full load per cycle- (l)	61
Water Consumption (Washing) full load per cycle (l)	53
Annual Water Consumption (Washing & Drying)- (l) <sup>(3)</sup>	12200
Annual Water Consumption (Washing) (l) <sup>(3)</sup>	10600
Spin-drying efficiency class (1)	A
Maximum spin speed (rpm)	1400
Airborne acoustical noise emissions washing/spinning/drying (dB)	55/77/69
Built-in	No
Rated capacity - Washing (kg)	9
Rated capacity - Drying (kg)	6
Height (cm)	84
Width (cm)	60
Depth (cm)	63
Net weight (±4 kg.)	89
Single Water inlet / Double Water inlet	• / -
• Available	
Electrical input (V/Hz)	230 V / 50Hz
Total current (A)	10
Total power (W)	2200
VDE Main model code	9614

<sup>(1)</sup> Scale from A (Highest Efficiency) to G (Lowest Efficiency)

<sup>(2)</sup> Energy Consumption based on 200 standard washing cycles - full loads washing (and drying). Actual energy consumption will depend on how the appliance is used.

<sup>(3)</sup> Water consumption based on 200 standard washing cycles - full loads washing (and drying). Actual energy consumption will depend on how the appliance is used.

Technical specifications may be changed without prior notice to improve the quality of the product.

# Installation

To make the product ready for use, review the information in the user manual and take care that the electricity, tap water supply and water drainage systems are appropriate. If they are not, call a qualified technician and plumber to have any necessary arrangements carried out.

## DANGER



- **Have the installation and electrical connections of the product made by competent persons. Manufacturer shall not be held liable for damages that may arise from procedures carried out by unauthorized persons.**

## DANGER



- **Product The weight of your product is not suitable to be carried by one person.**

## CAUTION



- Prior to installation, visually check if the product has any defects on it. If so, do not have it installed. Damaged products cause risks for your safety.

## CAUTION



- Preparation of the location and electrical, tap water and waste water installations at the place of installation are under customer's responsibility.
- Make sure that the water inlet and discharge hoses as well as the power cable are not folded, pinched or crushed while pushing the product into its place after installation or cleaning procedures.

## Appropriate installation location

- Place the machine on a rigid floor. Do not place it on a long pile rug or similar surfaces.
- Do not place the product on the power cable.
- Do not install the product at places where temperature may fall below 0°C. (See, Warnings for drying)
- Place the product at least 1.5 cm away from the edges of other furniture.
- There should not be any lockable, sliding or hinged door that may restrain the loading door to open fully in the installation place of this product.
- Operate the product in a well-ventilated and dust-free environment.



## Removing packaging reinforcement



Tilt the machine backwards to remove the packaging reinforcement. Remove the packaging reinforcement by pulling the ribbon.

### DANGER



- **The product is heavy. Remove the packaging reinforcement as illustrated.**
- **Pay attention not to squeeze your hand under the machine during this procedure.**

## Removing the transportation locks

### CAUTION



- Do not remove the transportation locks before taking out the packaging reinforcement.
- Remove the transportation safety bolts before operating the washing machine! Otherwise, the product will be damaged.

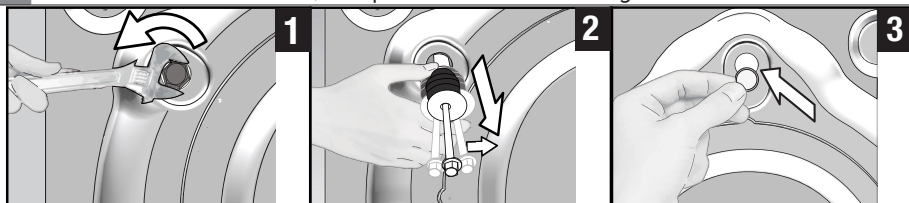

- Loosen all bolts with the tool supplied in the User Manual bag until they turn freely.
- Remove transportation safety bolts by turning them gently.
- Attach the plastic covers supplied in the User Manual bag into the holes on the rear panel.

### NOTE



- *Keep the transportation safety bolts in a safe place to reuse when the machine needs to be moved again in the future.*
- *Never move the product without the transportation safety bolts properly fixed in place!*

## Flush usage with the bench

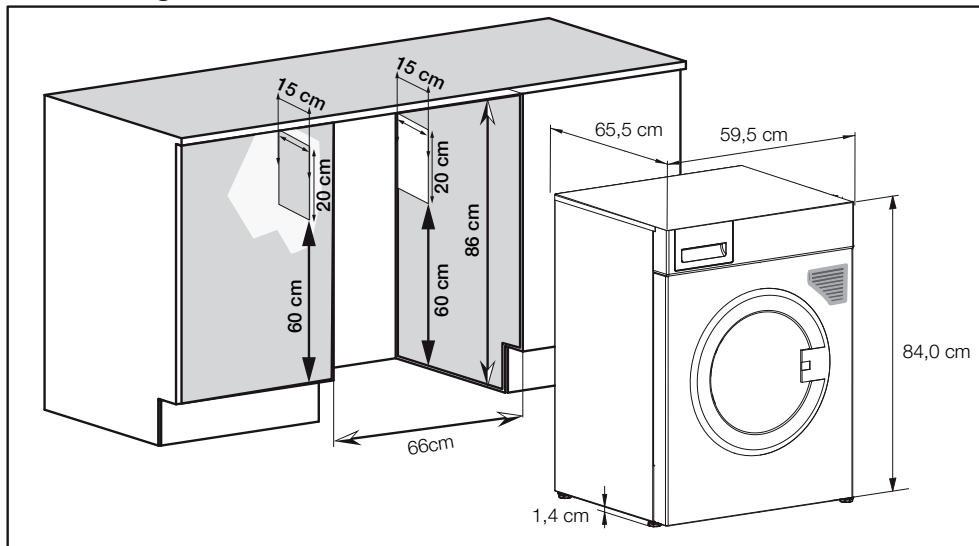

### CAUTION



- Your machine should never be operated without the top plate.
- When the Washer-Dryer is placed under the bench, front of the machine should never be blocked by the cupboard door.
- When the Washer-Dryer is placed under the bench, air vents must be bored into the left and right sides of the cupboard.

### NOTE



- Follow the above dimensions when installing the product under the bench. These dimensions are indispensable to avoid any change in the performance of your machine.
- Drying washing machine can be used under a bench if the height of the bench allows.
- At least 3 cm clearance must be left between the sides and the back of the product and the wall when it is installed under the bench or in a cupboard.

## Connecting water supply

EN

### NOTE



- The water supply pressure required to run the product is between 1 to 10 bars (0.1 – 1 MPa). It is necessary to have 10 – 80 litres of water flowing from the fully open tap in one minute to have your machine run smoothly. Attach a pressure reducing valve if water pressure is higher.
- If you are going to use the double water-inlet product as a single (cold) water-inlet unit, you must install the supplied blind stopper to the hot water valve before operating the product. (Applies for the products supplied with a blind stopper group.)

### CAUTION



- Models with a single water inlet should not be connected to the hot water tap. In such a case the laundry will get damaged or the product will switch to protection mode and will not operate.
- Do not use old or used water inlet hoses on the new product. It may cause stains on your laundry.

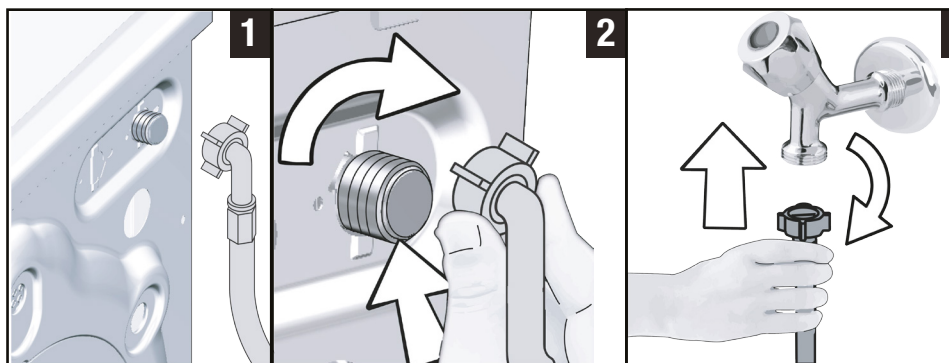

- Connect the special hoses supplied with the product to the water inlets on the product. Red hose (left) (max. 90 °C) is for hot water inlet, blue hose (right) (max. 25 °C) is for cold water inlet.

### CAUTION



- Ensure that the cold and hot water connections are made correctly when installing the product. Otherwise, your laundry will come out hot at the end of the washing process and wear out.
- Tighten all hose nuts by hand. Never use a tool when tightening the nuts.
- Open the taps completely after making the hose connection to check for water leaks at the connection points. If any leaks occur, turn off the tap and remove the nut. Retighten the nut carefully after checking the seal. To prevent possible water leakages, keep the taps closed when the machine is not in use.

## Connecting to the drain

- Connect the end of the drain hose directly to the wastewater drain, sink or to the washbasin.

### CAUTION



- Your house will be flooded if the hose comes out of its housing during water discharge. Moreover, there is risk of scalding due to high washing temperatures! To prevent such situations and to ensure smooth water intake and discharge of the machine, fix the end of the discharge hose tightly so that it cannot come out.

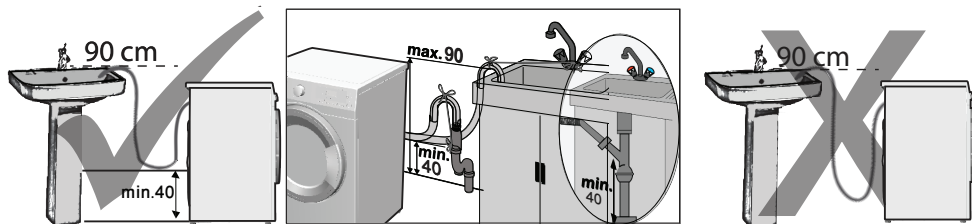

- The distance to the wall so that the machine be placed up to 30 cm.
- Attach the hose at a height of at least 40 cm, and 90 cm at most.
- In case the hose is elevated after laying it on the floor level or close to the ground (less than 40 cm above the ground), water discharge becomes more difficult and the laundry may come out excessively wet. Therefore, follow the heights described in the figure.
- To prevent flowing of waste water back into the machine and to allow for easy discharge, do not immerse the hose end into the waste water or do not drive it in the drain more than 15 cm. If it is too long, cut it short.
- Pay care not to bend the end of the hose, step on it or pinch the hose between the drain and the machine.
- If the length of the hose is too short, use it by adding an original extension hose. Length of the hose may not be longer than 3.2 m. To avoid water leak failures, the connection between the extension hose and the drain hose of the product must be fitted well with an appropriate clamp as not to come off and leak.

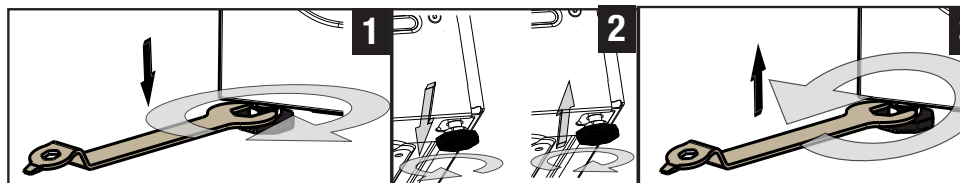
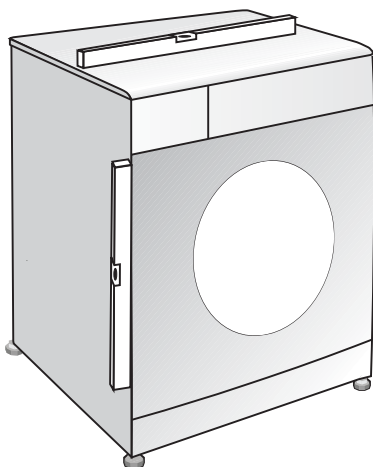

### CAUTION



• In order to ensure that the product operates more silently and vibration-free, it must stand level and balanced on its feet. Balance the machine by adjusting the feet. Otherwise, the product may move from its place and cause crushing and vibration problems.

- Loosen the nuts on the feet in the direction of arrow with the tool supplied in the User Manual bag.
- Adjust the feet until the product stands level and balanced. You can move the feet downwards by turning them counterclockwise or upwards by turning clockwise.
- Tighten all lock nuts again in the direction of arrow by the tool supplied. You can move the nuts upwards by turning them counterclockwise or downwards by turning clockwise.

## Electrical connection

Connect the product to a grounded outlet protected by a 16 A fuse. Our company shall not be liable for any damages that will arise when the product is used without grounding in accordance with the local regulations.

- Connection must comply with national regulations.
- The wiring for the electrical outlet circuit must be sufficient to meet the appliance requirements. Use of a Ground Fault Circuit Interrupter (GFCI) is recommended.
- Power cable plug must be within easy reach after installation.
- If the current fuse or circuit breaker is less than 16 Amperes, please have a qualified electrician install a 16 Ampere fuse or circuit breaker.
- The voltage specified in the "Technical specifications" section must be equal to your mains voltage.



### DANGER

- **Damaged power cables must be replaced by the Authorized Service Agents.**

#### Important

#### Fitting a different plug

As the colours of the wires in the mains lead of this appliance may not correspond with the coloured markings identifying the terminals on your plug, proceed as follows:

- Connect the green - yellow or green (earth) wire to the terminal in the plug marked 'E' or with the symbol  $\perp$  or coloured green and yellow or green.
- Connect the blue (neutral) wire to the terminal in the plug marked 'N' or coloured black.
- Connect the brown (live) wire to the terminal in the plug marked 'L' or coloured red.

With the alternative plugs a 16A fuse must be fitted either in the plug or adaptor or in the main fuse box. If in doubt contact a qualified electrician.

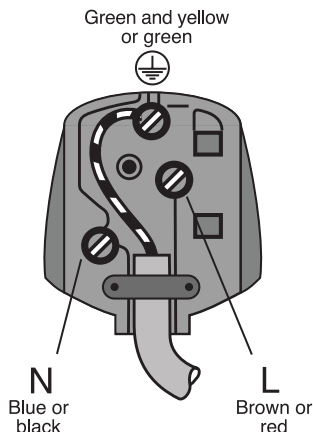

## Transportation of the product

- Unplug the product before transporting it.
- Remove water drain and water supply connections.
- Drain all water that has remained in the product.
- Install transportation safety bolts in the reverse order of removal procedure;

### DANGER



- **The weight of your product is not suitable to be carried by one person.**
- **The product is heavy; it should be carried by two persons very carefully on the stairs. Falling of your product on you may cause disabilities.**



### CAUTION











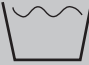























- Packaging materials are dangerous to children. Keep packaging materials in a safe place away from reach of the children.



### NOTE

- *Never move the product without the transportation safety bolts properly fixed in place!*

# Preparation

LAUNDRY WASH SYMBOLS																														
 <b>WASH</b>	Machine Wash Symbols		Normal wash			No Iron			Sensitive-Delicate wash			Hand wash			Not washable			No Spin												
	Water Temperatures	Maximum	95°C	70°C	60°C	50°C	40°C	30°C																						
	Symbol(s)	•••	••	••	••	•••	••	•																						
 <b>DRYING</b>	Drying Symbols		Suitable for dryer			No Iron			Sensitive / Delicate dry			Do not dry with dryer			Do not dry			Do not dry-clean												
	Drying Settings											At any temperature		At high temperature		At medium temperature		At low temperature		Without heating		Hang to dry		Lay to dry		Hang wet to dry		Lay in shadow to dry		Dry-cleanable
 <b>IRON</b>	Iron -				Iron at high temperature			Iron at medium temperature			Iron at low temperature			Do not iron			Iron without steam													
	Dry or Steam			200 °C		150 °C		110 °C																						
	Maximum temperature																													
 <b>BLEACH</b>				All bleaches are allowed			Bleach (sodium hypochlorite) can be used			Bleach is not allowed			Only bleaches without chlorine are allowed																	

## Sorting the laundry

- Sort laundry according to type of fabric, colour, and degree of soiling and allowable water temperature.
- Always obey the instructions given on the garment tags.



## Preparing laundry for washing

- Laundry items with metal attachments such as, underwired bras, belt buckles or metal buttons will damage the machine. Remove the metal pieces or wash the clothes by putting them in a cotton laundry bag or cotton pillow case. Moreover, such clothes may warm up excessively during drying and get damaged. For this reason, do not dry such laundry in the machine.
- Put small size clothes such as infant's socks and nylon stockings in a cotton laundry bag or cotton pillow case.
- Place curtains in without compressing them. Remove curtain attachment items. Do not dry tulle curtains in the machine.
- Fasten zippers, sew loose buttons and mend rips and tears.
- Wash "machine washable" or "hand washable" labelled products only with an appropriate programme. Do not dry such clothes in the machine; either hang or spread them to dry.
- Do not wash colours and whites together. New, dark coloured cottons release a lot of dye. Wash them separately.
- Use only dyes/colour changers and limescale removers suitable for machine wash. Always follow the instructions on the package.

### NOTE



- *Laundry that are subjected to materials such as flour, lime dust, milk powder, etc. intensely must be shaken off before placing into the machine. Such dusts and powders on the laundry may build up on the inner parts of the machine in time and can cause damage.*
- *Keep laundry items made of Angora wool in the freezer for a few hours before washing. This will reduce pilling.*
- *Wash trousers and delicate laundry turned inside out.*
- *Tough stains must be treated properly before washing. If unsure, check with a dry cleaner.*
- *Take out all substances in the pockets such as coins, pens and paper clips, and turn pockets inside out and brush. Such objects may damage the product or cause noise problem.*

## Things to be done for energy saving

Following information will help you use the product in an ecological and energy-efficient manner.

- Operate the product in the highest capacity allowed by the programme you have selected, but do not overload. See, "Programme and consumption table".
- Always follow the instructions on the detergent packaging.
- Wash slightly soiled laundry at low temperatures.
- Use faster programmes for small quantities of lightly soiled laundry.
- Do not use prewash and high temperatures for laundry that is not heavily soiled or stained.
- If you plan to dry your laundry, select the highest spin speed recommended during washing process.
- Do not use detergent in excess of the amount recommended on the detergent package.

## First use

Before starting to use the product, make sure that all preparations are completed in accordance with the instructions in sections "Important safety and environment instructions" and "Installation".



To prepare the product for washing laundry, perform first operation in Drum Cleaning programme.

### NOTE



- Use an anti-limescale suitable for the washing machines.
- Some water might have remained in the product due to the quality control processes in the production. It is not harmful for the product.

## Correct load capacity

The maximum load capacity depends on the type of laundry, the degree of soiling and the washing programme desired.

The machine automatically adjusts the amount of water according to the weight of the loaded laundry.

### WARNING



- Follow the information in the “Programme and consumption table”. When overloaded, machine's washing performance will drop. Moreover, noise and vibration problems may occur. For a good drying performance, do not dry laundry more than the amounts specified.

Laundry type	Weight (g)	Laundry type	Weight (g)
Bathrobe	1200	Hand towel	100
Napkin	100	Evening gown	200
Duvet cover	700	Underclothing	100
Bed Sheet	500	Men's overalls	600
Pillowcase	200	Men's shirt	200
Tablecloth	250	Men's pajamas	500
Towel	200	Blouses	100

## Loading the laundry

- Open the loading door.
- Place laundry items loosely into the machine.
- Push the loading door to close until you hear a locking sound. Ensure that no items are caught in the door.

### NOTE



- *The loading door is locked while a programme is running. The door can only be opened a while after the programme comes to an end. The loading door will not open until the temperature drops if the inside of the machine is very hot at the end of the programme.*

### WARNING



- In case of misplacing the laundry, noise and vibration problems may occur in the machine.

## Using detergent and softener

### NOTE



- When using detergent, softener, starch, fabric dye, bleach or limescale remover read the manufacturer's instructions on the package carefully and follow the suggested dosage values. Use measuring cup if available.

### Detergent drawer

The detergent drawer is composed of three compartments:

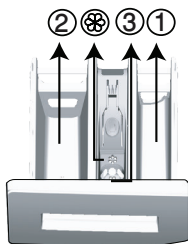

- (1) for prewash
- (2) for main wash
- (3) for softener
- (\*) in addition, there is siphon piece in the softener compartment.

### Detergent, softener and other cleaning agents

- Add detergent and softener before starting the washing programme.
- Never leave the detergent drawer open while the washing programme is running!
- When using a programme without prewash, do not put any detergent into the prewash compartment (compartment nr. "1").
- In a programme with prewash, do not put liquid detergent into the prewash compartment (compartment nr. "1").
- Do not select a programme with prewash if you are using a detergent bag or dispensing ball. Place the detergent bag or the dispensing ball directly among the laundry in the machine.
- If you are using liquid detergent, do not forget to place the liquid detergent cup into the main wash compartment (compartment nr. "2").
- Do not add any washing chemicals (liquid detergent, softener, etc.) when the machine is in drying step.

## Choosing the detergent type

The type of detergent to be used depends on the type and colour of the fabric.

- Use different detergents for coloured and white laundry.
- Wash your delicate clothes only with special detergents (liquid detergent, wool shampoo, etc.) used solely for delicate clothes.
- When washing dark coloured clothes and quilts, it is recommended to use liquid detergent.
- Wash woollens with special detergent made specifically for woollens.

### WARNING



- Use only detergents manufactured specifically for washing machines.
- Do not use Powdered Soap.

## Adjusting detergent amount

The amount of washing detergent to be used depends on the amount of laundry, the degree of soiling and water hardness.

- Do not use amounts exceeding the dosage quantities recommended on the detergent package to avoid problems of excessive foam, poor rinsing, financial savings and finally, environmental protection.
- Use lesser detergent for small amounts or lightly soiled clothes.

## Using softeners

Pour the softener into the softener compartment of the detergent drawer.

- Do not exceed the (>max<) level marking in the softener compartment.
- If the softener has lost its fluidity, dilute it with water before putting it in the detergent drawer.

## Using liquid detergents

### If the product has a liquid detergent cup

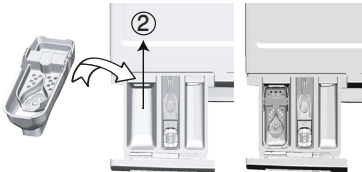

- Place the liquid detergent cup in compartment nr. "2".
- If the liquid detergent has lost its fluidity, dilute it with water before putting in the detergent cup.

### **If the product does not have a liquid detergent cup**

- Do not use liquid detergent for the prewash in a programme with prewash.
- Liquid detergent stains your clothes when used with Delayed Start function. If you are going to use the Delayed Start function, do not use liquid detergent.

### **Using gel and tablet detergent**

- If the gel detergent thickness is fluidal and your machine does not contain a special liquid detergent cup, put the gel detergent into the main wash detergent compartment during first water intake. If your machine contains a liquid detergent cup, fill the detergent into this cup before starting the programme.
- If the gel detergent thickness is not fluidal or in the shape of capsule liquid tablet, put it directly into the drum before washing.
- Put tablet detergents into the main wash compartment (compartment nr. "2") or directly into the drum before washing.

#### **NOTE**



- *Tablet detergents may leave residues in the detergent compartment. If you encounter such a case, place the tablet detergent between the laundry, close to the lower part of the drum in future washings.*
- *Use the tablet or gel detergent without selecting the prewash function.*

### **Using starch**

- Add liquid starch, powder starch or the fabric dye into the softener compartment.
- Do not use softener and starch together in a washing cycle.
- Wipe the inside of the machine with a damp and clean cloth after using starch.

## Using bleaches

- Select a programme with prewash and add the bleaching agent at the beginning of the prewash. Do not put detergent in the prewash compartment. As an alternative application, select a programme with extra rinse and add the bleaching agent through an empty compartment of the detergent drawer as soon as the first rinsing step appears on the display, and add 1 glass of water in the same compartment.
- Do not use bleaching agent and detergent by mixing them.
- Use just a little amount (approx. 50 ml) of bleaching agent and rinse the clothes very well as it causes skin irritation. Do not pour the bleaching agent onto the clothes and do not use it for coloured clothes.
- When using oxygen based bleaches, select a programme that washes at a lower temperature.
- Oxygen based bleaches can be used together with detergents; however, if its thickness is not the same with the detergent, put the detergent first into the compartment nr. "2" in the detergent drawer and wait until the detergent flows while the machine is taking in water. Add the bleaching agent from the same compartment while the machine is still taking in water.

## Using limescale remover

- When required, use limescale removers manufactured specifically for washing machines only.

# Operating the product

## Control panel

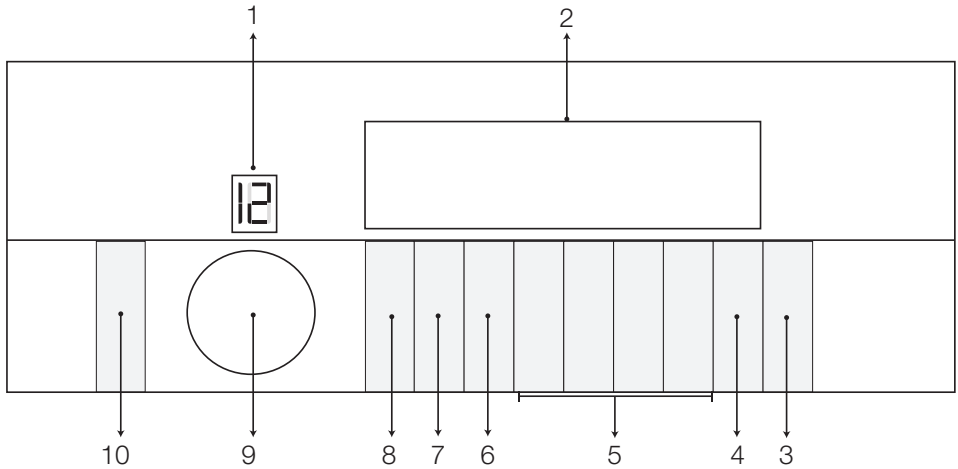

- 1 - Programme Selection display
- 2 - Display
- 3 - Start / Pause button
- 4 - End Time Adjustment button
- 5 - Auxiliary Function buttons
- 6 - Drying Level Adjustment button
- 7 - Spin Speed Adjustment button
- 8 - Temperature Adjustment button
- 9 - Programme Selection knob
- 10 - On / Off button



## Display symbols

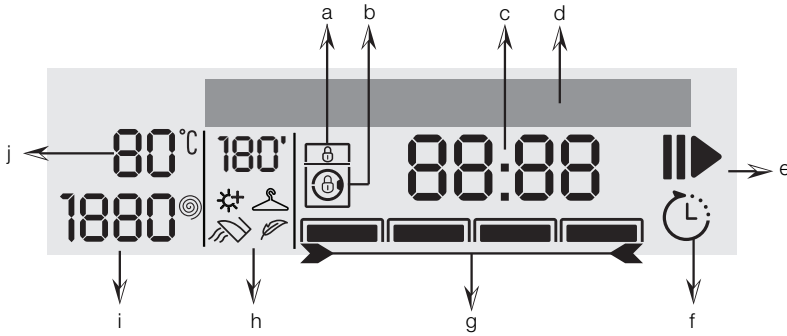

- a - Key Locked symbol
- b - Door Locked symbol
- c - Time indicator (hours:minutes)
- d - Display Information line
- e - Start / Pause indicator
- f - Delayed Start indicator
- g - Auxiliary Function indicators
- h - Drying Degrees indicator (minutes)
- i - Spin Speed indicator (rpm)
- j - Temperature indicator (°C )

### Preparing the machine

- Check if the hoses are connected tightly.
- Plug in your machine.
- Turn the tap on completely.
- Place the laundry in the machine.
- Add detergent and fabric softener.

## Program selection and tips for washing

- Select the programme suitable for the type, quantity and soiling level of the laundry in accordance with the "Programme and consumption table" and the temperature table below.
- Select the desired programme with the **Programme Selection** knob.

	Clothes			
	Light colours and whites	Colours	Dark colours	Delicates/ Woollens/Silks
	(Recommended temperature range based on soiling level: 40-90 °C)	(Recommended temperature range based on soiling level: cold -40 °C)	(Recommended temperature range based on soiling level: cold -40 °C)	(Recommended temperature range based on soiling level: cold -30 °C)
<b>Heavily Soiled</b> (difficult stains such as grass, coffee, fruits and blood.)	It may be necessary to pre-treat the stains or perform prewash. Powder and liquid detergents recommended for whites can be used at dosages recommended for heavily soiled clothes. It is recommended to use powder detergents to clean clay and soil stains and the stains that are sensitive to bleaches.	Powder and liquid detergents recommended for colours can be used at dosages recommended for heavily soiled clothes. It is recommended to use powder detergents to clean clay and soil stains and the stains that are sensitive to bleaches. Use detergents without bleach.	Liquid detergents suitable for colours and dark colours can be used at dosages recommended for heavily soiled clothes.	Prefer liquid detergents produced for delicate clothes. Woollen and silk clothes must be washed with special woollen detergents.
<b>Normally Soiled</b> (For example, stains caused by body on collars and cuffs)	Powder and liquid detergents recommended for whites can be used at dosages recommended for normally soiled clothes.	Powder and liquid detergents recommended for colours can be used at dosages recommended for normally soiled clothes. Use detergents without bleach.	Liquid detergents suitable for colours and dark colours can be used at dosages recommended for normally soiled clothes.	Prefer liquid detergents produced for delicate clothes. Woollen and silk clothes must be washed with special woollen detergents.
<b>Lightly Soiled</b> (No visible stains exist.)	Powder and liquid detergents recommended for whites can be used at dosages recommended for lightly soiled clothes.	Powder and liquid detergents recommended for colours can be used at dosages recommended for lightly soiled clothes. Use detergents without bleach.	Liquid detergents suitable for colours and dark colours can be used at dosages recommended for lightly soiled clothes.	Prefer liquid detergents produced for delicate clothes. Woollen and silk clothes must be washed with special woollen detergents.

## Washing programs

Depending on the type of fabric, use the following main programmes.

### NOTE



- You can make drying directly after washing by pressing the Drying button after selecting the programme you want to wash your laundry with. The step in which the drying will be made will be displayed on the information line every time you press the button, and the related symbol lights. If you like, you can make drying for maximum allowed time by keeping on pressing the button.
- Figures and inscriptions included in the programme steps are schematic and may not match the product exactly. .
- Name of the programme you have selected by the programme selection knob will appear on the display of the machine.
- If you do not want to have drying made after the programme you selected, press the Drying button until "Drying cancelled" is displayed.
- Load maximum 6kg laundry when you are going to make washing and drying by using the Drying function of the machine. If it is overloaded, the laundry will not dry and the machine will run for a longer time and consume extra power.

### • Cottons

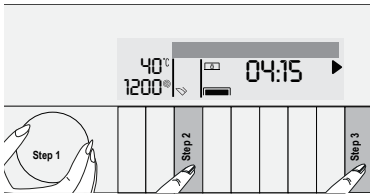

Use this programme for your cotton laundry (such as bed sheets, duvet and pillowcase sets, towels, bathrobes, underwear, etc.). Your laundry will be washed with vigorous washing action for a longer washing cycle.

### NOTE



- You can dry your laundry immediately after washing them (Automatic or scheduled drying can be made after washing). For this, you have to select the drying function too before starting the washing programme.
- 1. Step 1 is to select washing and drying programme.
- 2. Step 2 is to specify a drying function and its grade.
- 3. Step 3 is to start the selected programme.
- You can see the remaining time of the programme depending on the drying options you have added to the washing programme.

## • Synthetics

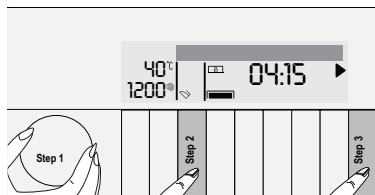

Use this programme to wash your synthetic clothes (shirts, blouses, synthetic/cotton blends, etc.). It washes with a gentle action and has a shorter washing cycle compared to the Cotton programme.

For curtains and tulle, use the Synthetic 40°C programme with prewash and anti-creasing functions selected. As their meshed texture causes excessive foaming, wash the veils/tulle by putting little amount of detergent into the main wash compartment. Do not put detergent in the prewash compartment.

### NOTE

- You can dry your laundry immediately after washing them (Automatic or scheduled drying can be made after washing). For this, you have to select the drying function too before starting the washing programme.
- 1. Step 1 is to select washing and drying programme.
- 2. Step 2 is to specify a drying function and its grade.
- 3. Step 3 is to start the selected programme.
- You can see the remaining time of the programme depending on the drying options you have added to the washing programme.

## • WoolProtect

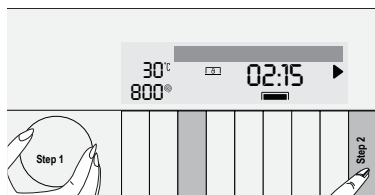

Use this programme to wash your woollen clothes. Select the appropriate temperature complying with the tags of your clothes. Use appropriate detergents for woollens.

### NOTE

- Drying function cannot be selected in the washing programme for woollens.

## • Cottons Eco

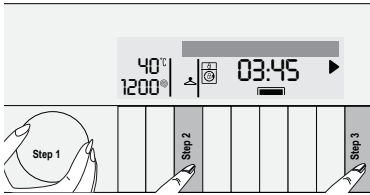

Use this programme to wash your normally soiled, durable cotton and linen laundry. Although it washes longer than all other programmes, it provides high energy and water savings. Actual water temperature may be different from the stated wash temperature. When you load the machine with less laundry (e.g. ½ capacity or less), programme time may automatically get shorter. In this case, energy and water consumption will decrease more, providing a more economic wash. This programme is available in the models with the remaining time indicator.

### NOTE



- You can dry your laundry immediately after washing them (Automatic or scheduled drying can be made after washing). For this, you have to select the drying function too before starting the washing programme.
- 1. Step 1 is to select washing and drying programme.
- 2. Step 2 is to specify a drying function and its grade.
- 3. Step 3 is to start the selected programme.
- You can see the remaining time of the programme depending on the drying options you have added to the washing programme.

## • Delicates

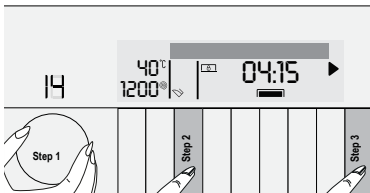

Use this programme to wash your delicate clothes. It washes with a gentler action compared to the Synthetics programme.

## • Hand Wash

Use this programme to wash your woollen/delicate clothes that bear “not machine-washable” tags and for which hand wash is recommended. It washes laundry with a very gentle washing action to not to damage clothes.

### • Mini 14'

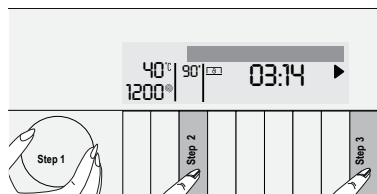

Use this programme to wash your small amounts of lightly soiled cotton laundry in a short time. It washes your laundry in 14 minutes.

#### NOTE



- You can dry your laundry immediately after washing them (Automatic or scheduled drying can be made after washing). For this, you have to select the drying function too before starting the washing programme.
- 1. Step 1 is to select washing and drying programme.
- 2. Step 2 is to specify a drying function and its grade.
- 3. Step 3 is to start the selected programme.
- You can see the remaining time of the programme depending on the drying options you have added to the washing programme.

### • AquaPerfect 40°/40'

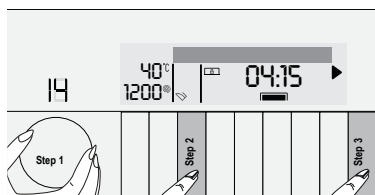

Use this programme to wash your lightly soiled and unstained cotton laundry in a short time.

#### • Rinse

Use this programme when you want to rinse or starch separately.

#### • Spin + Drain

Use this programme to drain the water in the machine.

## • Waterproofing

Use this programme to make your synthetic, synthetic/cotton and cotton laundry water-repellent, or stain-repellent against water-based stains such as fruit juice, coke, wine etc Use the programme only on clean laundry as indicated below:

Load the clean laundry. Do not load more than 2.5 kg of laundry.

Select the finishing programme.

Select the appropriate temperature looking at the labels of the garments.

Start the program.

Shake the finishing agent. During the water intake, fill the main washing compartment of the detergent drawer (compartment no II) with the recommended amount of finishing agent (see. „Finishing programme table“).

After the programme is completed remove the laundry.

Do not load more than 2.5 kg of laundry for this programme. Otherwise the result will be unsatisfactory.

\* If the product has dryer functionality or if you have a separate dryer, you can get a better finishing result using the appropriate drying programme. See the label of the garments to select an appropriate drying programme. If you cannot dry in the machine, you can get a better finishing result with ironing following the warning indicated on the labels of the garments.

\*\* Do not use the finishing agent in other appliances other than washing machine or in processes (such as hand wash).

Waterproofing programme table	
Laundry Type	Recommended Amount of Finishing Agent*
Synthetics	75 ml
Cottons	75 ml
Synthetic / Cottons	75 ml

## Temperature selection

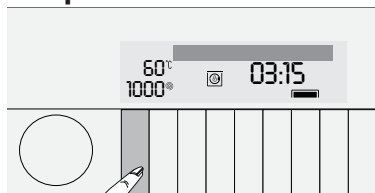

Whenever a new programme is selected, the recommended temperature for the programme appears on the temperature indicator. It is possible that the recommended temperature value is not the maximum temperature that can be selected for the current programme.

Press the **Temperature Adjustment** button to change the temperature. Temperature will decrease by steps of 10 °C.

### NOTE



- *Temperature Adjustment button works backwards only. For example, if you wish to select 60°C when 40°C is displayed on the screen, you need to press the button in a row to go back from 40°C until you reach 60°C.*
- *When you press the Temperature Adjustment button in programs not allowing temperature setting, "Unadjustable" warning is displayed.*

You can also change the temperature after the washing starts. However, if the step where temperature could be changed has passed, temperature cannot be selected. "Unadjustable" warning will be displayed if you press the Temperature button.



## Selecting the spin speed

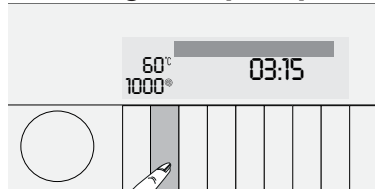

Whenever a new programme is selected, the recommended spin speed for the selected programme is displayed on the **Spin Speed** indicator.

### NOTE



- *It is possible that the recommended spin speed value is not the maximum spin speed that can be selected for the current programme.*

Press the **Spin Speed Adjustment** button to change the spin speed. Spin speed decreases gradually.

Then, depending on the model of the product, "Rinse Hold" and "No Spin" options appear on the display.

### NOTE



- *Spin Speed Adjustment button works backwards only. For example, if you wish to select 1000 rpm when 800 rpm is displayed on the screen, you need to press the button in a row to go back from 800 rpm until you reach 1000 rpm.*

### If you want to spin your laundry after the Rinse Hold function:

- Adjust the **Spin Speed**.

- Press **Start / Pause / Cancel** button. Program resumes. Machine discharges the water and spins the laundry.

If you want to discharge the water at the end of the programme without spinning, use **No Spin** function.

### NOTE



- *Light of the Spin Speed indicator is off in the programmes that do not allow the adjustment of spin speed. When you press the Spin Speed Adjustment button, "Not adjustable" appears on the display.*

You can also change the Spin Speed after the washing starts. However, if the step where spin speed could be changed has passed, spin speed cannot be selected.

"Unadjustable" warning will be displayed if you press the Spin Speed button.

## Drying Programmes

### WARNING



- Piles coming from the clothes during drying are automatically cleaned by the machine. Water is automatically taken in to perform cleaning. For this reason, water tap of the machine should also be open during drying programmes.

### NOTE



- *Spinning step already exists in the drying programmes. Your machine carries out this process to shorten the drying time. When drying is selected, spin speed setting is in the 1200 - Maximum rpm range.*
- *You product features air condensing washing technology. In each selected drying programme your product will automatically clean the condenser and the related components.*

### • Synthetic Dry

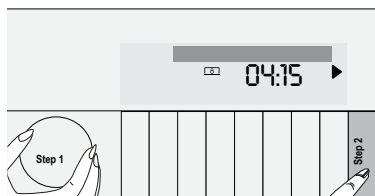

This programme is used to dry humid or previously spun synthetic clothes whose dry weight corresponds to 4 kg. This programme performs drying only. The highest spinning process possible should be applied to wet synthetic clothes prior to the drying programme. This process increases efficiency of the drying programme and ensures better dryness of clothes.

### NOTE



- *For dry weights of laundry, see Section 4, Step 4.5*

## • Cotton Dry

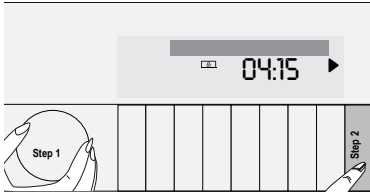

This programme is used to dry humid or previously spun cotton clothes whose dry weight corresponds to 6 kg. This programme performs drying only. The highest spinning process possible should be applied to wet synthetic clothes prior to the drying programme. This process increases efficiency of the drying programme and ensures better dryness of clothes.

### NOTE



- Load 4.5kg of laundry to dry the towels and bathrobes only.
- For dry weights of laundry, see Section 4, Step 4.5

## Washing and Drying Programmes

### WARNING



- Piles coming from the clothes during drying are automatically cleaned by the machine. Water is automatically taken in to perform cleaning. For this reason, water tap of the machine should also be open during drying programmes.

### • 6 kg Wash&Dry

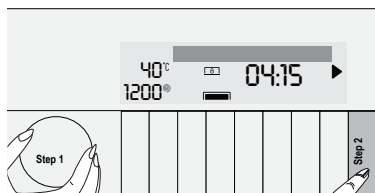

Use this programme to wash cotton clothes up to 6 kg and dry them immediately afterwards without making any selection.

### NOTE



- *Auxiliary additional drying function cannot be selected when this programme is selected.*

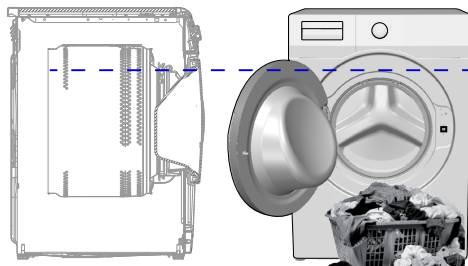

For the 6Kg Wash & 6kg Dry cycle, we advise you to load the laundry to the appliance up to the level specified in the figure above (level arrow is shown with the door of the product open) for ideal drying conditions.

## • Mini Wash&Dry

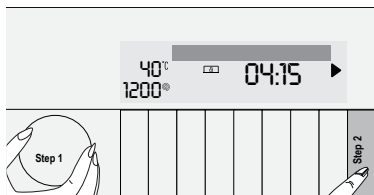

Use this programme to wash and dry 0.5 kg of laundry (2 shirts) in 34 minutes and 1 kg of laundry (5 shirts) in 55 minutes.

### NOTE



- Use this programme to quickly wash and dry daily clothes worn for a short time and taken off recently. It is suitable for fine-textured, quickly drying laundry. (Shirt, T-Shirt)
- Other drying options or programmes should be used for coarse-textured and slowly drying clothes.

## • HygieneCare Wash&Dry

Up to 2 kg, use this programme to wash and immediately dry your laundry for which you require anti-allergic and hygienic results (baby clothes, bed linens, duvet cover, underwear, etc.).

### NOTE



- HygieneCare+ Wash & Dry 60°C programme is tested and approved by "The British Allergy Foundation" (Allergy UK) in United Kingdom.

# Tips for efficient drying

Cloth Types		Programmes			
		Cottons Drying	Synthetics Drying	Antiallergic+	Wash&Dry
Durable Cotton Blend Clothes	Synthetics (Polyester, nylon etc.):  Not recommended!	Bed sheets, duvet covers, baby clothes, t-shirts, sweatshirts, knitwear, blue jeans, canvas trousers, shirts, cotton socks, and alike	Not recommended!	Washes and dries directly! Bed sheets, duvet covers, baby clothes, t-shirts, sweatshirts, knitwear, blue jeans, canvas trousers, shirts, cotton socks, and alike	Washes and dries directly! Bed sheets, duvet covers, baby clothes, t-shirts, sweatshirts, knitwear, blue jeans, canvas trousers, shirts, cotton socks, and alike
Delicate (Silk, Woollen, Cashmere, Angora etc.) Clothes	Duvet, jacket, curtain, etc. voluminous laundry	Not recommended! Drying voluminous laundry in the machine is not appropriate. Dry them by hanging or spreading.	Not recommended! Drying voluminous laundry in the machine is not appropriate. Dry them by hanging or spreading.	Not recommended! Drying voluminous laundry in the machine is not appropriate. Dry them by hanging or spreading.	Not recommended! Drying voluminous laundry in the machine is not appropriate. Dry them by hanging or spreading.

# Programme and consumption table

(For washing)

EN						Auxiliary functions				Selectable temperature range °C
	Programme (°C)	Max. Load (kg)	Water Consumption (l)	Energy Consumption (kWh)	Max. Speed**	Prewash	Extra Rinse	Drying	Silent Mode	
Cottons	90	9	95	2,55	1400	•	•	•	•	90-Cold
	60	9	95	2,05	1400	•	•	•	•	90-Cold
	40	9	95	1,35	1400	•	•	•	•	90-Cold
Cottons Eco	60**	9	53	1,03	1400			•		60-Cold
	40	9	53	0,80	1400			•		60-Cold
Synthetics	60	4	65	1,20	1200	•	•	•	•	60-Cold
	40	4	65	0,65	1200	•	•	•	•	60-Cold
WoolProtect	40	2	45	0,30	1200		•			40-Cold
Delicates	40	4	50	0,40	1000	•				40-Cold
Hand Wash	30	1,5	40	0,21	1200					30-Cold
Mini 14'	30	2	35	0,10	1400		•	•		30-Cold
AquaPerfect 40°/40'	40	9	45	0,75	1200			•		40
Waterproofing	40	2,5	20	1,90	1000			•		40-Cold

• : Selectable.

\* : Automatically selected, not cancellable.

\*\* : Energy Label programme (EN 50229)

\*\*\*: If maximum spin speed of the machine is lower then this value, you can only select up to the maximum spin speed.

\*\*\*\*: Programme detects the type and quantity of the laundry to automatically adjust water and energy consumption and programme time.

- : See the programme description for maximum load.

## NOTE



- "Selectability of auxiliary functions might be changed by the manufacturer. New selectabilities might be added or existing ones might be removed."
- "The spin speed of your machine may vary among the programmes, however this speed cannot exceed the max. spin speed of your machine."

## Program and consumption table (For drying)

EN						Auxiliary functions				Drying level					
Programme (°C)		Max. Load (kg)	Water Consumption (l)	Energy Consumption (kWh)	Max. Speed***	Prewash	Extra Rinse	Silent Mode	Drying	Extra wardrobe dry	Wardrobe dry	Iron dry	Delicate drying	Time based drying - minutes	Selectable temperature range °C
Cotton Dry	-	6	4	2,7	1400				*	•	•	•	•		-
Synthetic Dry	-	4	4	2,45	-				*	•	•	•	•		-
HygieneCare Wash&Dry	60	2	84	2,9	1400		*		*	•	•	•	•		90-30
6 Kg Wash&Dry	60	6	64	5,3	1400				*	•	•	•	•		60-Cold
Mini Wash&Dry	30	0,5	28	0,6	1000		•		*				•		30-Cold
Mini Wash&Dry	30	1	28	1	1000		•		*				•		30-Cold

### NOTE

#### Information for the testing organizations;

#### Information for the testing organizations;

Washing performance tests for EU energy labelling are performed in „Cottons Eco 60°C“ programme as per the EN 50229 standard.

According to the EN 50229 standard for EU energy labelling drying performance, the maximum washing load must be divided into groups as the maximum drying load and the remaining drying load, and then each load must be dried using the option „Cottons Drying Extra Dry.“





## Auxiliary function selection

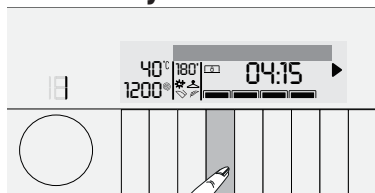

Select the required auxiliary functions before starting the program. Whenever a programme is selected, frames of the auxiliary function symbols that can be selected together with it illuminate. And when you select an auxiliary function, the interior area of the auxiliary function symbol also starts to illuminate and the name of the selected function appears on display for "3" seconds.

### NOTE



- *Frame of the auxiliary function symbol that cannot be selected with the current programme will not illuminate. When you press the button of such auxiliary functions, "Not adjustable" appears on the display for 3 seconds.*

Also the frames of the auxiliary function suitable for the current programme after the washing has started remains illuminated. You can select or cancel the auxiliary functions whose frames are illuminated. If the wash cycle has reached a point where you cannot select the auxiliary function, the function's frame goes off.

### NOTE



- *Some functions cannot be selected together. If a second auxiliary function conflicting with the first one is selected before starting the machine, the function selected first will be cancelled and the second auxiliary function selection will remain active. For example, if you want to select Quick Wash after you have selected the Prewash, Prewash will be cancelled and Quick Wash will remain active.*
- *Auxiliary function that is not compatible with the program cannot be selected. (See "Programme and consumption table")*
- *Some programmes have auxiliary functions that must be operated simultaneously. Those functions cannot be cancelled. The frame of the auxiliary function will not be illuminated, only inner area will be illuminated.*
- *The machine will extend the duration of the programme automatically unless the required dampness level (ironing, wardrobe, extra wardrobe and delicate) is reached at the end of the drying. Programme will last longer.*
- *If time based drying is selected, the programme will be ended even if the laundry is still wet at the end of the programme.*
- *The machine will shorten the duration of the programme if the required dampness level (ironing, wardrobe, extra wardrobe and delicate) is reached during the drying operations or in time based drying selections. A time decrease will be seen on the display.*

- **Prewash**

A Prewash is only worthwhile for heavily soiled laundry. Not using the Prewash will save energy, water, detergent and time.

- **Extra Rinse**

This function enables the machine to make another rinsing in addition to the one already made after the main wash. Thus, the risk for sensitive skins (babies, allergic skins, etc.) to be effected by the minimal detergent remnants on the laundry can be reduced.



#### NOTE

- *Pressing for the first time will add single rinse, a second press will add double rinse. The third press will cancel it.*

- **Silent Mode**

Use to wash the cottons with lesser energy consumption and silently. Spin steps are cancelled for a silent washing and the cycle ends with the Rinse Hold step. After completion of the programme, run Spin cycle to spin the laundry.

- **Drying**

This function provides drying of laundry after washing. Check from the programme table in which programmes this auxiliary function is selectable.

## Drying Steps

### Iron dry

Drying is carried on until dryness level of laundry reaches **Iron Dry** level. Laundry taken out at the end of this programme have to be ironed.

### Wardrobe dry

Drying is carried on until dryness level of laundry reaches **Wardrobe Dry** level.

### Extra wardrobe dry

Drying is carried on until dryness level of laundry reaches **Extra Wardrobe Dry** level.

### Delicate drying

Use this programme to dry 100% synthetic and synthetic blend sateen type underwear (nightwear, upper underwear, lower underwear, pajamas) which are dryable as per washing instructions.

**NOTE**

- Dryness level may change due to the blend, weave/knit type, amount and dampness level of the laundry.
- Products that contain accessories such as lace, tulle, stone, bead, spangle, wire and products with high content of silk should not be dried in the machine.
- Silk blend clothes containing cotton or have a sateen appearance may remain damp when dried in this programme.

**Time-based drying - minutes**

You may select either of 10', 20', 30', 60', 90', 120' and 150' drying times to reach the final drying degree at low temperature.

**NOTE**

- For drying laundry up to two pieces, you should prefer timed drying steps in the cotton or synthetic drying programmes to be selected according to the type of the laundry.
- When you select 10' drying function, only Aeration and Cooling is performed.
- If the laundry is not dry as required after the drying programmes, you should prefer timed drying steps in the cotton or synthetic drying programmes to be selected according to the type of the laundry.
- When this function is selected, machine performs drying up to the set time independent of the drying degree.

**Time display**

Remaining time for the completion of the programme while it is running is displayed as "01:30" in hours and minutes format.

**NOTE**

- Programme time may differ from the values in the "Programme and consumption table" depending on the water pressure, water hardness and temperature, ambient temperature, amount and the type of laundry, auxiliary functions selected and the changes at the mains voltage.

## End Time

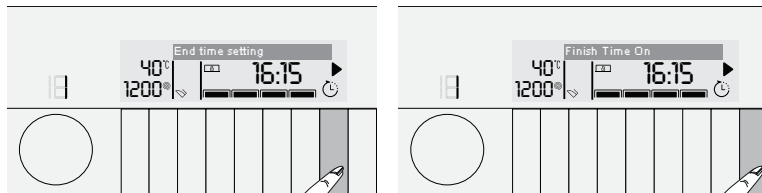

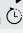
With the **End Time** function, the startup of the programme may be delayed up to 24 hours. After pressing **End Time** button, the displayed time is the programme's estimated end time. If the **End Time** is adjusted, **End Time** indicator is illuminated. "**End Time Setting**" label appears on the display. At the same time, the end time symbol  lights up. Meantime, **Start / Pause** button flashes.

In order for the End Time function is activated and the programme is completed at the end of the specified time, you must press **Start / Pause** button after adjusting the time. "**Finish Time On**" appears on the display when you press the button. **Start / Pause** button stops flashing and remains illuminated continuously.

If you want to cancel End Time function, press **End Time** button until the End Time indicator turns off or press **On / Off** button to turn off and on the machine.

- Open the loading door, place the laundry and put detergent, etc.
- Select the washing programme, temperature, spin speed and, if required, the auxiliary functions.
- Set the end time of your choice by pressing the **End Time** button. **End Time** indicator illuminates.
- Press **Start / Pause** button. Time countdown starts. ":" sign in the middle of the end time on the display starts flashing.

### NOTE



- *Do not use liquid detergents when you activate End Time function! There is the risk of staining of the clothes.*
- *Loading door remains locked during the End Time countdown period. Machine must be switched to Pause mode by pressing the Start/Pause button to open the loading door. At the end of the countdown, End Time indicator turns off, washing cycle starts and the time of the selected programme appears on the display.*
- *When the End Time selection is completed, the time appearing on the screen consists of end time plus the duration of the selected programme.*

## Starting the programme

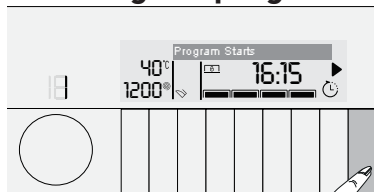

- Press **Start / Pause** button to start the programme.
- The **Start / Pause** button which was flashing starts to illuminate steadily now, indicating that the programme has started. "Program started" appears on the display for "3" seconds.
- Loading door is locked. "Door is Closing" appears on the display when the door is being locked.

## Loading door lock

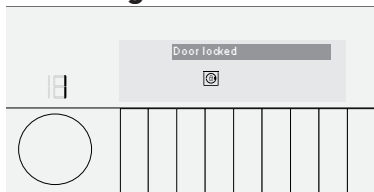

There is a locking system on the loading door of the machine that prevents opening of the door in cases when the water level is unsuitable.

"Door is Locked" appears on the display when the loading door is locked.

**NOTE**

- Door also remains locked when the temperature is high.

## Changing the selections after programme has started

### Adding laundry after the programme has started:

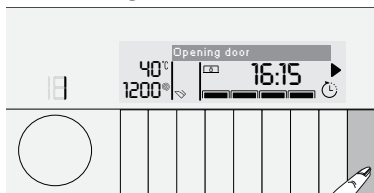

If the water level in the machine is suitable when you press Start / Pause button, "Door is opening" will appear on the display.

If the water level in the machine is not suitable when you press Start / Pause button, the display will show that the loading door is locked.

### Switching the machine to pause mode:

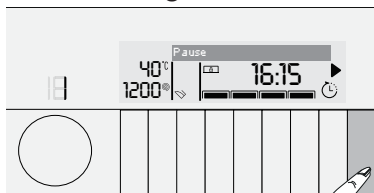

Press the Start / Pause button to switch the machine to pause mode. The frame around the Start / Pause button starts flashing. "Pause" appears on the display.

## Changing the programme selection after programme has started:

The programme change is not allowed when the current programme is running. If you turn the **Programme Selection** knob while the programme is running, "Pause to make changes" appears on the display.

You can select the new programme after switching the current programme to pause.

### NOTE



- *The selected program starts anew.*

## Changing the auxiliary function, speed and temperature settings

Depending on the step the programme has reached, you can cancel or activate the auxiliary functions; see, "Auxiliary function selection".

You can also change the speed, temperature and drying settings; see, "Spin speed selection" and "Temperature selection".

### NOTE



- *The loading door will not open if the water temperature in the machine is high or the water level is above the door opening.*

## Child Lock

Use Child Lock function to prevent children from tampering with the machine. Thus you can avoid any changes in a running programme.

### NOTE



- *You can switch on and off the machine with On / Off button when the Child Lock is active. When you switch on the machine again, programme will resume from where it has stopped.*
- *If you press any button when the Child Lock is activated, the machine will give an audible warning. Audible warning will be cancelled when the buttons are pressed 5 times in a row. The warning phrase on the screen goes on to be displayed.*

## To activate the Child Lock:

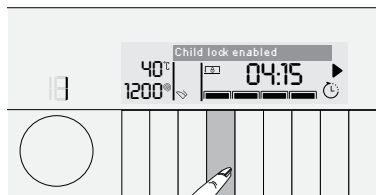

Press and hold **2<sup>nd</sup> Auxiliary Function** button for 3 seconds. After the countdown as "Child Lock 3-2-1" on the display is over, "Child Lock Enabled" appears on the display. You can release **2<sup>nd</sup> Auxiliary Function** button when this warning is displayed.

### NOTE



- "Child Lock Enabled" appears on the display if you press any button when Child Lock is enabled.

## To deactivate the Child Lock:

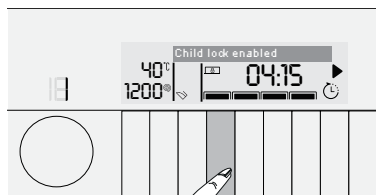

Press and hold **2<sup>nd</sup> Auxiliary Function** button for 3 seconds. After the countdown as "Child Lock 3-2-1" on the display is over, "Child Lock Disabled" appears on the display.

## Cancelling the programme

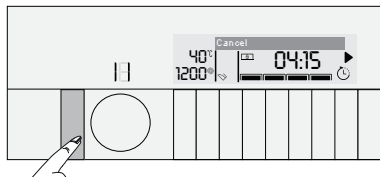

The programme is cancelled when the machine is turned off and on again. Press and hold **On / Off** button for 3 seconds. After the countdown as "Cancel 3-2-1" on the display is over, the machine turns off.

### NOTE



- If you press On / Off button when the Child Lock is enabled, the programme will not be cancelled. You should cancel the Child Lock first. Countdown as "Pause 3-2-1" appears on the display.
- If you have to open the loading door after you have cancelled the programme, but it is not possible to open the loading door since the water level in the machine is above the loading door level, then turn the Programme Selection knob to Pump+Spin programme and select No Spin to discharge the water in the machine.
- When programme is cancelled during drying, it may not be possible to open the door as the inside temperature is high.
- To unlock the door, if you see the warning "Wait to cool down"...
- Select one of the Cotton Drying or Synthetic Drying programmes and run 10 min. of drying.

## End of programme

"Laundry can be taken out" appears on the display when the programme is completed.

If you do not press any button for 2 minutes, the machine will switch to pause mode. Display and all indicators are turned off. Only the frame of the **Programme Selection** knob remains flashing.

If you press any button or turn the **Programme Selection** knob when the machine is in pause mode, programme steps that are completed will appear on the display.



## Entering the Settings menu

You can perform the following operations in Settings menu:

- Changing the language selection,
- Changing the screen brightness setting,
- Muting and unmuting the sound,

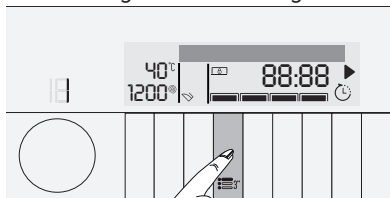

Press and hold **1st Auxiliary Function** button for 3 seconds to open the Settings menu. “Volume” menu will be displayed.

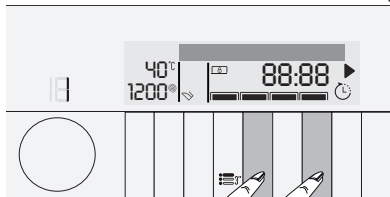

Use **2nd Auxiliary Function** or **4th Auxiliary Function** buttons to navigate within menus.

### Changing the language selection

- Press and hold **1st Auxiliary Function** button for 3 seconds to open the Settings menu. Open “Select Language” menu using **2nd Auxiliary Function** or **4th Auxiliary Function** buttons.
- Press **3rd Auxiliary Function** button until the desired language appears on the display in Select Language menu.
- When the desired language is displayed, selected language is saved firstly pressing **2nd or 4th Auxiliary Function** buttons then **3rd Auxiliary Function** button.
- Press and hold **1st Auxiliary Function** button for 3 seconds when the desired Language Setting is displayed.

## Changing the screen brightness setting

- Press and hold **1st Auxiliary Function** button for 3 seconds to open the Settings menu. Open “Brightness” menu using **2nd Auxiliary Function** or **4th Auxiliary Function** buttons.
- Press **3rd Auxiliary Function** button until the desired brightness option appears on the display in Brightness menu.
- Press and hold **1st Auxiliary Function** button for 3 seconds when the desired Brightness option is displayed.

## Muting and unmuting the Audible Warning

- Press and hold **1st Auxiliary Function** button for 3 seconds to open the Settings menu. Open “Volume” menu using **2nd Auxiliary Function** or **4th Auxiliary Function** buttons.
- Press **3rd Auxiliary Function** button until the desired volume option appears on the display in Volume menu.
- Press and hold **1st Auxiliary Function** button for 3 seconds when the desired Volume is displayed.

## Restoring the factory settings

- Press and hold **1st Auxiliary Function** button for 3 seconds to open the Settings menu. Open “Factory Settings” menu using **2nd Auxiliary Function** or **4th Auxiliary Function** button.
- Press **3rd Auxiliary Function** button until the Factory Settings message is displayed.
- When the Factory Settings message is displayed, Factory Settings are restored firstly pressing **2nd or 4th Auxiliary Function** buttons then **3rd Auxiliary Function** button.
- Press and hold **1st Auxiliary Function** button for 3 seconds to exit.

When the factory settings are restored:

- Display language will return to the first language you selected when you have operated your machine for the first time,
- Brightness is set to maximum level,
- Sound is unmuted,

## Memory programme setting

You can create a favourite programme by saving frequently used programme and other settings. Use this function when you want to select quickly the same settings you use for the laundry that you wash regularly.

Favourite programme will remain at the factory set programme until you make a new favourite programme setting.

### To store a new favourite programme:

- Select the desired temperature, speed and auxiliary function in the programme where you are allowed to set memory programme.
- Keep the **Favourite** button pressed for 3 seconds.
- Countdown as "Storing favourite 3-2-1" appears on the display.



#### NOTE

- *If storing is not successful, "Favourite not saved" appears on the display.*

### To select a favourite programme:

- Press **Favourite** button. "Favourite selected" appears on the display.
- Programme and other settings saved as favourite appear on the display.
- Press **Start / Pause** button to start your Favourite programme.

## Your machine is equipped with a "Standby Mode"

In case of not starting any programme or waiting without making any other operation when the machine is turned on by On/Off button and while it is in selection step or if no other operation is performed approximately 2 minutes after the programme you selected has come to an end, your machine will automatically switch to energy saving mode. Brightness of indicator lights will decrease. Also, if your product is equipped with a display showing the programme duration, this display will completely turn off. In case of rotating the Programme Selection knob or pressing any button, lights and display will restore to their previous condition. Your selections made while exiting the energy saving mode may change. Check the appropriateness of your selections before starting the programme. Readjust if necessary. This is not a fault.

# Maintenance and cleaning

Service life of the product extends and frequently faced problems decrease if cleaned at regular intervals.

## Cleaning the detergent drawer

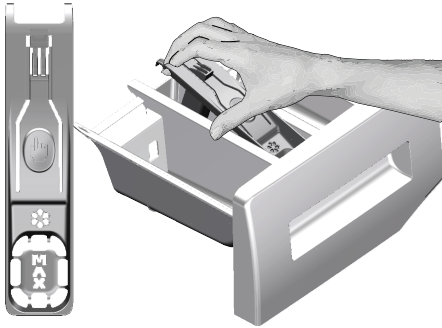

Clean the detergent drawer at regular intervals (every 4-5 washing cycles) as shown below in order to prevent accumulation of powder detergent in time.

- Lift the rear part of the siphon to remove it as illustrated. After performing the cleaning procedures explained below, replace the siphon back to its seating and push its front section downwards to be sure that the locking tab engages.

### NOTE



- *If more than normal amount of water and softener mixture starts to gather in the softener compartment, clean the siphon.*

- Wash the detergent drawer and the siphon with plenty of lukewarm water in a washbasin. Wear protective gloves or use an appropriate brush to avoid touching of the residues in the drawer with your skin when cleaning.
- After cleaning, seat the siphon well in its place and insert the drawer back.

## Cleaning the loading door and the drum

### Drum cleaning

For products with drum cleaning programme, please see Operating the product - Programmes.

For products without drum cleaning, follow the below steps **to clean the drum**: Select **Additional Water** or **Extra Rinse** auxiliary functions. Use a Cottons **programme** without pre-wash. Set **the temperature to the level recommended on the drum cleaning agent which can be provided from authorized services**. Apply this procedure **without any laundry in the product**. Before starting the programme, put 1 pouch of special drum cleaning agent (if the special agent could not be supplied, put max. 100 g of powder anti-limescale) into the main wash detergent compartment (compartment no. "2"). If the anti-limescale is in tablet form, put only one tablet into the main wash compartment no. "2". Dry the inside of the bellow with a clean piece of cloth after the programme has come to an end.

### NOTE



- *Repeat Drum Cleaning process in every 2 months.*
- *Use an anti-limescale suitable for the washing machines.*



After every washing check that no foreign substance is left in the drum. If the holes on the bellow shown in the figure is blocked, open the holes using a toothpick.

#### NOTE



- Foreign metal substances will cause rust stains in the drum. Clean the stains on the drum surface by using cleaning agents for stainless steel. Never use steel wool or wire wool.



#### CAUTION

- Never use sponge or scrub materials. These will damage the painted and plastic surfaces.

## Cleaning the air suction filter

To clean the air suction filter:

Unplug the machine.

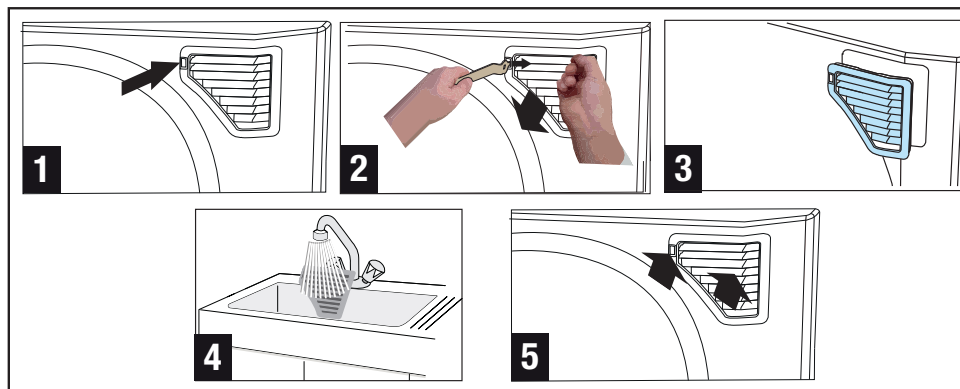

- Attach the rear of the tool supplied in the Operation Manual bag to the place on the filter cap illustrated in Fig. 1.
- Pull the filter cap towards yourself with the help of a finger after pulling the latch leftwise with the back side of the apparatus as illustrated in Fig. 2.
- Filter cap will come out easily.
- Wash the filter cap.
- Replace the filter cap and make sure that it seats well. If not seated twist the latch to the right with the help of the apparatus.

## CAUTION



- Never use sponge or scrub materials. These will damage the painted and plastic surfaces.
- After every 50 washing and drying operation (approx. 3 months), clean the air suction filter of the machine.
- If the machine is operated only for drying for 10 times in a row, always perform an empty washing afterwards by using 1 short programme.

### Cleaning the body and control panel

Wipe the body of the machine with soapy water or non-corrosive mild gel detergents as necessary, and dry with a soft cloth.

Use only a soft and damp cloth to clean the control panel.

### Cleaning the water intake filters

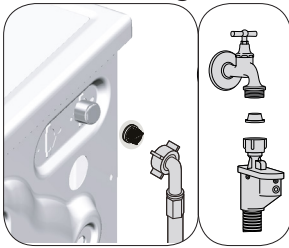

There is a filter at the end of each water intake valve at the rear of the machine and also at the end of each water intake hose where they are connected to the tap. These filters prevent foreign substances and dirt in the water to enter the washing machine. Filters should be cleaned as they do get dirty.

- Close the taps.
- Remove the nuts of the water intake hoses to access the filters on the water intake valves. Clean them with an appropriate brush. If the filters are too dirty, take them out by means of pliers and clean them.
- Take out the filters on the flat ends of the water intake hoses together with the gaskets and clean thoroughly under running water.
- Replace the gaskets and filters carefully in their places and tighten the hose nuts by hand.

### Draining remaining water and cleaning the pump filter

The filter system in your machine prevents solid items such as buttons, coins and fabric fibers clogging the pump impeller during discharge of washing water. Thus, the water will be discharged without any problem and the service life of the pump will extend.

If the machine fails to drain water, the pump filter is clogged. Filter must be cleaned whenever it is clogged or in every 3 months. Water must be drained off first to clean the pump filter.

In addition, prior to transporting the machine (e.g., when moving to another house) and in case of freezing of the water, water may have to be drained completely.

**CAUTION**

- Foreign substances left in the pump filter may damage the machine or may cause noise problem.
- If the product is not in use, turn the tap off, detach the supply hose and drain the water inside the machine against any freezing possibility in the region of installation.
- After each use close the supply hose tap of the product.

**In order to clean the dirty filter and discharge the water:**

- Unplug the machine to cut off the supply power.

**CAUTION**

- Temperature of the water inside the machine may rise up to 90 °C. To avoid burning risk, cleaned the filter after the water in the machine cools down.

- Open the filter cap.
- Press the tab on the filter cap downwards and pull the piece out towards yourself.

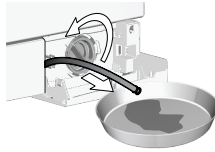
**To discharge the water:**

- Pull the emergency draining hose out from its seat
- Place a large container at the end of the hose. Drain the water into the container by pulling out the plug at the end of the hose. When the container is full, block the inlet of the hose by replacing the plug. After the container is emptied, repeat the above procedure to drain the water in the machine completely.
- When draining of water is finished, close the end by the plug again and fix the hose in its place.
- Turn the pump filter to take it out.

# Troubleshooting

## Program does not start after closing the door.

- “ Start / Pause / Cancel button was not pressed. >>> *\*Press the Start / Pause / Cancel button.*
- “ It may be difficult to close the loading door in case of excessive loading.. >>> *Reduce the amount of laundry and make sure that the loading door is closed properly.*

## Programme cannot be started or selected.

- “ Machine has switched to self protection mode due to a supply problem (line voltage, water pressure, etc.). >>> *Press and hold On / Off button for 3 seconds to reset the machine to factory settings. (See “Cancelling the programme”)*

## Water in the machine.

- “ Some water might have remained in the product due to the quality control processes in the production. >>> *This is not a failure; water is not harmful to the machine.*

## There is water leaking from the bottom of the machine.

- “ Likely problems with hoses or the pump filter. >>> *Be sure the seals of the water inlet hoses are securely fitted. Attach the hose to the tap tightly.*
- “ Pump filter might not be closed fully. >>> *Check if the pump filter is completely closed.*

## Machine does not fill with water.

- “ Tap is turned off. >>> *Open the taps.*
- “ Water inlet hose is bent. >>> *Correct the hose.*
- “ Water inlet filter is clogged. >>> *Clean the filter.*
- “ The loading door is ajar. >>> *Close the Loading Door.*

## Machine does not drain water.

- “ Water drain hose might be clogged or twisted. >>> *Clean or flatten the hose.*
- “ Pump filter is clogged. >>> *Clean the pump filter.*

## Machine vibrates or makes noise.

- “ Machine might be standing unbalanced. >>> *Adjust the feet to level the machine.*
- “ A hard substance might have entered into the pump filter. >>> *Clean the pump filter.*
- “ Transportation safety bolts are not removed. >>> *Remove the transportation safety bolts.*
- “ Laundry quantity in the machine might be too little. >>> *Add more laundry to the machine.*
- “ Machine might be overloaded with laundry. >>> *Take out some of the laundry from the machine or distribute the load by hand to balance it homogenously in the machine.*
- “ Machine might be leaning on a rigid item. >>> *Check if the machine is not leaning on anything.*

## Machine stopped shortly after the programme started.

- “ Machine might have stopped temporarily due to low voltage. >>> *It will resume running when the voltage restores to the normal level.*



**Machine directly discharges the water it takes in.**

- “ Draining hose might not be at adequate height. >>> *Connect the water draining hose as described in the operation manual.*

**No water can be seen in the machine during washing.**

- “ The water level is not visible from outside of the washing machine. This is not a failure.

**Loading door cannot be opened.**

- “ Door lock is activated because of the water level in the machine. >>> *Drain the water by running the Pump or Spin programme.*
- “ Machine is heating up the water or it is at the spinning cycle. >>> *Wait until the programme completes.*
- “ Child lock is engaged. Door lock will be deactivated a couple of minutes after the programme has come to an end. >>> *Wait for a couple of minutes for deactivation of the door lock.*
- “ Loading door may be stuck because of the pressure it is subjected to.>>> *Grab the handle and push and pull the loading door to release and open it.*

**Washing takes longer than the specified in the manual. [\*]**

- “ Water pressure is low. >>> *Machine waits until taking in adequate amount of water to prevent poor washing quality due to the decreased amount of water. Therefore, the washing time extends.*
- “ Voltage might be low. >>> *Washing time is prolonged to avoid poor washing results when the supply voltage is low.*
- “ Input temperature of water might be low. >>> *Required time to heat up the water extends in cold seasons. Also, washing time can be lengthened to avoid poor washing results.*
- “ Number of rinses and/or amount of rinse water might have increased. >>> *Machine increases the amount of rinse water when good rinsing is needed and adds an extra rinsing step if necessary.*
- “ Excessive foam might have occurred and automatic foam absorption system might have been activated due to too much detergent usage. >>> *Use recommended amount of detergent.*

**Programme time does not countdown. (On models with display) [\*]**

- “ Timer may stop during water intake. >>> *Timer indicator will not countdown until the machine takes in adequate amount of water. The machine will wait until there is sufficient amount of water to avoid poor washing results due to lack of water. Timer indicator will resume countdown after this.*
- “ Timer may stop during heating step. >>> *Timer indicator will not countdown until the machine reaches the selected temperature.*
- “ Timer may stop during spinning step. >>> *Automatic unbalanced load detection system might be activated due to the unbalanced distribution of the laundry in the drum.*

**Programme time does not countdown. [\*]**

- “ There might be an imbalance of laundry in the machine. >>> *Automatic unbalanced load detection system might be activated due to the unbalanced distribution of the laundry in the drum.*

### **Machine does not switch to spinning step. (\*)**

- .. There might be an imbalance of laundry in the machine. >>> *Automatic unbalanced load detection system might be activated due to the unbalanced distribution of the laundry in the drum.*
- .. The machine will not spin if water is not drained completely. >>> *Check the filter and the draining hose.*
- .. Excessive foam might have occurred and automatic foam absorption system might have been activated due to too much detergent usage. >>> *Use recommended amount of detergent.*

### **Washing performance is poor: Laundry turns gray. (\*\*)**

- .. Insufficient amount of detergent was used over a long period of time. >>> *Use the recommended amount of detergent appropriate for water hardness and the laundry.*
- .. Washing was made at low temperatures for a long time over a long period of time. >>> *Select the proper temperature for the laundry to be washed.*
- .. Insufficient amount of detergent is used with hard waters. >>> *Using insufficient amount of detergent with hard water causes the soil to stick on the cloth and this turns the cloth into gray in time. It is difficult to eliminate graying once it happens. Use the recommended amount of detergent appropriate for water hardness and the laundry.*
- .. Too much detergent is used. >>> *Use the recommended amount of detergent appropriate for water hardness and the laundry.*

### **Washing performance is poor: Stains persist or the laundry is not whitened. (\*\*)**

- .. Insufficient amount of detergent is used. >>> *Use recommended amount of detergent appropriate for the laundry.*
- .. Excessive laundry was loaded in. >>> *Do not load the machine in excess. Load with amounts recommended in the "Programme and consumption table".*
- .. Wrong programme and temperature were selected. >>> *Select the proper programme and temperature for the laundry to be washed.*
- .. Wrong type of detergent is used. >>> *Use original detergent appropriate for the machine.*
- .. Detergent is put in the wrong compartment. >>> *Put the detergent in the correct compartment. Do not mix the bleaching agent and the detergent with each other.*

### **Washing performance is poor: Oily stains appeared on the laundry. (\*\*)**

- .. Regular drum cleaning is not applied. >>> *Clean the drum regularly. For this, please see 6.2.*

### **Washing performance is poor: Clothes smell unpleasantly. (\*\*)**

- .. Odours and bacteria layers are formed on the drum as a result of continuous washing at lower temperatures and/or in short programmes. >>> *Leave the detergent drawer as well as the loading door of the machine ajar after each washing. Thus, a humid environment favorable for bacteria cannot occur in the machine.*

**Colour of the clothes faded. (\*\*)**

- .. Excessive laundry was loaded in. >>> *Do not load the machine in excess.*
- .. Detergent in use is damp. >>> *Keep detergents closed in an environment free of humidity and do not expose them to excessive temperatures.*
- .. A higher temperature is selected. >>> *Select the proper programme and temperature according to the type and soiling degree of the laundry.*

**It does not rinse well.**

- .. The amount, brand and storage conditions of the detergent used are inappropriate. >>> *Use a detergent appropriate for the washing machine and your laundry. Keep detergents closed in an environment free of humidity and do not expose them to excessive temperatures.*
- .. Detergent is put in the wrong compartment. >>> *If detergent is put in the prewash compartment although prewash cycle is not selected, machine can take this detergent during rinsing or softener step. Put the detergent in the correct compartment.*
- .. Pump filter is clogged. >>> *Check the filter.*
- .. Drain hose is folded. >>> *Check the drain hose.*

**Laundry became stiff after washing. (\*\*)**

- .. Insufficient amount of detergent is used. >>> *Using insufficient amount of detergent for the water hardness can cause the laundry to become stiff in time. Use appropriate amount of detergent according to the water hardness.*
- .. Detergent is put in the wrong compartment. >>> *If detergent is put in the prewash compartment although prewash cycle is not selected, machine can take this detergent during rinsing or softener step. Put the detergent in the correct compartment.*
- .. Detergent might be mixed with the softener. >>> *Do not mix the softener with detergent. Wash and clean the dispenser with hot water.*

**Laundry does not smell like the softener. (\*\*)**

- .. Detergent is put in the wrong compartment. >>> *If detergent is put in the prewash compartment although prewash cycle is not selected, machine can take this detergent during rinsing or softener step. Wash and clean the dispenser with hot water. Put the detergent in the correct compartment.*
- .. Detergent might be mixed with the softener. >>> *Do not mix the softener with detergent. Wash and clean the dispenser with hot water.*

**Detergent residue in the detergent drawer. (\*\*)**

- .. Detergent is put in wet drawer. >>> *Dry the detergent drawer before putting in detergent.*
- .. Detergent has gotten damp. >>> *Keep detergents closed in an environment free of humidity and do not expose them to excessive temperatures.*
- .. Water pressure is low. >>> *Check the water pressure.*
- .. The detergent in the main wash compartment got wet while taking in the prewash water. Holes of the detergent compartment are blocked. >>> *Check the holes and clean if they are clogged.*
- .. There is a problem with the detergent drawer valves. >>> *Call the Authorised Service Agent.*
- .. Detergent might be mixed with the softener. >>> *Do not mix the softener with detergent. Wash and clean the dispenser with hot water.*

#### **There is detergent left on the laundry. (\*\*)**

- .. Excessive laundry was loaded in. >>> *Do not load the machine in excess.*
- .. Wrong programme and temperature were selected. >>> *Select the proper programme and temperature for the laundry to be washed.*
- .. Wrong detergent was used. >>> *Select the proper detergent for the laundry to be washed.*

#### **Too much foam forms in the machine. (\*\*)**

- .. Improper detergents for the washing machine are being used. >>> *Use detergents appropriate for the washing machine.*
- .. Excessive amount of detergent is used. >>> *Use only sufficient amount of detergent.*
- .. Detergent was stored under improper conditions. >>> *Store detergent in a closed and dry location. Do not store in excessively hot places.*
- .. Some meshed laundry such as tulle may foam too much because of their texture. >>> *Use smaller amounts of detergent for this type of item.*
- .. Detergent is put in the wrong compartment. >>> *Put the detergent in the correct compartment.*
- .. Softener is being taken early. >>> *There may be problem in the valves or in the detergent dispenser. Call the Authorised Service Agent.*

#### **Foam is overflowing from the detergent drawer.**

- .. Too much detergent might be used. >>> *Mix 1 tablespoonful softener and ½ l water and pour into the main wash compartment of the detergent drawer.*
- .. Put detergent into the machine suitable for the programmes and maximum loads indicated in the "Programme and consumption table". When you use additional chemicals (stain removers, bleaches and etc), reduce the amount of detergent.

#### **Laundry remains wet at the end of the programme. (\*)**

- .. Excessive foam might have occurred and automatic foam absorption system might have been activated due to too much detergent usage. >>> *Use recommended amount of detergent.*

### Drying process lasts long.

- Pores of the Air inlet filter in front of the machine might be clogged. >>> *Wash the Air inlet filter with lukewarm water.*
- The Air inlet filter in front of the machine might be blocked. >>> *Remove everything, if any, that is blocking ventilation in front of the Air inlet filter.*
- Ventilation may be inadequate due to the very small area of installation. >>> *Open the doors and windows to avoid too much increase in the ambient temperature.*
- Excessive laundry was loaded in. >>> *Do not overload the Washer-Dryer.*
- Laundry may not have been spun adequately. >>> *Have the Washer-Dryer perform spin in a higher spin speed during washing step.*
- Tap is turned off. >>> *Open the taps.*

### Laundry remains wet at the end of drying.

- Improper programme might have been used for the laundry type >>> *Select a proper programme for the type of the laundry by checking the maintenance tags on the clothes or use time programmes additionally.*
- Pores of the Air inlet filter in front of the machine might be clogged. >>> *Wash the Air inlet filter with lukewarm water.*
- Excessive laundry was loaded in. >>> *Do not overload the Washer-Dryer.*
- Laundry may not have been spun adequately. >>> *Have the Washer-Dryer perform spin in a higher spin speed during washing step.*

### Machine does not turn on or the programme does not start.

- Power cable might not be plugged in. >>> *Make sure that the power cable is plugged in.*
- Programme might not be set or Start / Pause / Cancel button might not be pressed. >>> *Make sure that the program has been set and the machine is not in Pause mode.*
- Child lock might be enabled. >>> *Deactivate the Child Lock.*

### Laundry is shrunk, yellowed, felted or damaged.

- Improper programme might have been used for the laundry type >>> *Select a proper programme for the type of the laundry by checking the maintenance tags on the clothes or use time programmes additionally. Laundry not suitable for drying should not be dried.*

### Drying cannot be performed

- Laundry might not be dry or drying function has not been enabled. >>> *Check if drying function is also selected after the selected washing programme.*

### Loading door cannot be opened.

- Loading door of the machine may not be opened due to safety reasons. >>> *If "wait to cool down to open...." warning is displayed, machine will keep the loading door locked for your safety until it cools down. You can accelerate cooling by running any 10-minute drying programme.*

(\* ) Machine does not switch to spinning step when the laundry is not evenly distributed in the drum to prevent any damage to the machine and to its surrounding environment. Laundry should be rearranged and re-spun.

(\*\* ) Regular drum cleaning is not applied. >>> *Clean the drum regularly.*



### CAUTION

- If you cannot eliminate the problem although you follow the instructions in this section, consult your dealer or the Authorised Service Agent. Never try to repair a nonfunctional product yourself.

## Guarantee Details

Your new Grundig product is guaranteed against faulty materials, defective components or manufacturing defects. The guarantee starts from the date of original purchase of the product for a period of three (3) years unless Beko plc (the “Manufacturer”) agrees to extend the guarantee for the product in writing. If you have any questions about the guarantee on your product (including how long it is valid), please contact your retailer or our Call Centre on 0333 207 9920.

This guarantee does not in any way diminish or affect your statutory rights in connection with the product. This guarantee is in addition to your statutory rights as a consumer. If you have any question about these rights, please contact the retailer from which you purchased the product. In certain circumstances, it is possible that your statutory rights may offer additional or higher levels of protection than those offered under the terms of this guarantee.

### What is covered by this guarantee?

- Repairs to the product required as a result of faulty materials, defective components or manufacturing defects.
- Functional replacement parts to repair a product.
- The costs of a Grundig Approved Engineer to carry out the repair.

### What is not covered?

- Transit and delivery damage.
- Cabinet or appearance parts, including but not limited to control knobs, flaps and handles.
- Accessories and/or consumable items including but not limited to ice trays, scrapers, cutlery baskets, filters and light bulbs.
- Repairs necessary as a direct or indirect result of:
  - Accidental damage, misuse or abuse of a product.
  - An attempted repair of a product by anyone other than a Grundig Approved Engineer (the “Engineer”).
  - Installation or use of a product where such installation or use fails to meet the requirements contained in this guarantee or the User Instructions Booklet.
- Repairs to a product operated at any time on commercial or non-residential household premises (unless we have previously agreed to the installation environment).

This guarantee is limited to the cost of repairing the product. To the extent permitted by law, Beko plc (the “Manufacturer”) does not accept and will not be held liable for any financial loss incurred in connection with the failure of any product to operate in accordance with the expected standards. Such financial loss includes but is not limited to loss arising from:

- Time taken off work.
- Damaged food, clothing or other items.
- Meals taken at restaurants or from takeaways.

- General compensation for inconvenience.

## Important Notes

- Your product is designed and built for domestic household use only.
- The guarantee will automatically be void if the product is installed or is used in commercial or non-residential domestic household premises, unless we have previously agreed to the installation environment.
- The product must be correctly installed, located and operated in accordance with the instructions contained in the User Instructions Booklet provided with your product.
- Professional installation by a qualified Electrical Domestic Appliance Installer is recommended for all Washing Machines, Dishwashers and Electric Cookers (as incorrect installation may result in you having to pay for the cost of repairing the product).
- Gas Cookers must be professionally installed by a Gas Safe (or Gas Networks Ireland for Republic of Ireland) registered gas installer.
- This guarantee is given in respect of products purchased and used within the United Kingdom and the Republic of Ireland.
- This guarantee is effective from the initial date of purchase of a new product from an authorised retailer and will be void if the product is resold.
- This guarantee does not apply to graded sales (where the product is purchased as a “second”).
- Possession of a copy of these terms and conditions does not necessarily mean that a product has the benefit of this guarantee. If you have any questions, please call our Call Centre on the number set out above.
- The Manufacturer reserves the right to terminate the guarantee if its staff or representatives are subjected to physical or verbal abuse in the course of carrying out their duties.
- Optional extras, where available (i.e. extendable feet) are supplied on a chargeable basis only.

## Does Grundig offer replacements?

This is a repair-only guarantee. On occasion, the Manufacturer may at its sole discretion, replace your product with a new product instead of carrying out a repair. Where a replacement is offered, this would normally be an identical model, but when this is not possible, a model of similar specification will be provided. The Manufacturer will cover the costs and arrange for the delivery of the new product and for the return of the old product. Any costs related to disconnecting the faulty product and installing the replacement product will not be borne by the Manufacturer unless previously agreed to in writing. The original guarantee will continue to apply to the replacement product; the new product will not come with a new guarantee.

## When will the repair take place?

Our Engineers work Monday to Friday 9.00am to 5.00pm. Appointments outside these hours may be possible at the sole discretion of the Manufacturer but cannot be guaranteed. Whilst our Engineers will endeavour to minimize inconvenience and to meet requests for specific timed appointments, this cannot be guaranteed. We will not be liable for delays or if it is unable to carry out a repair because a convenient appointment cannot be arranged.

## Will there be any charge for the repairs?

It is your responsibility to provide evidence to the Engineer that your product is covered by this guarantee with a proof of purchase. The Manufacturer reserves the right to charge for the reasonable cost of any service call if:

- You cannot provide evidence that your product is covered by this guarantee.
- Where a service call has been made and the engineer finds that there is no fault with your product.
- That your product has not been installed or operated in accordance with the User Instructions Booklet.
- That the fault was caused by something other than faulty materials, defective components or manufacturing defects.
- For missed appointments.

Payment of these costs are due immediately upon the Engineer providing you with an invoice. The Manufacturer reserves the right to terminate the guarantee if you fail to pay the costs for the service call in a timely manner.

If you are a resident of the United Kingdom, this guarantee will be governed by English law and subject to the English Courts, save where you live in another part of the United Kingdom, in which case the law and courts of that location will apply.

If you are resident in the Republic of Ireland, this guarantee will be governed by Irish law and the Irish courts will have jurisdiction.

## HOW TO OBTAIN SERVICE

Please keep your purchase receipt or other proof of purchase in a safe place; you will need to have it should the product require attention under guarantee.

It will be useful if you complete the details below, as it will help us assist you when requesting service (the model number is printed on the Instruction Booklet and the serial number is printed on the Rating Label affixed to the appliance). Recording of these details alone will not count as proof of purchase. A valid proof of purchase is required for under guarantee service.

The area around the product must be easily accessible to the Engineer without the need for cabinets or furniture being removed.

It is your responsibility to ensure our Engineers have a clean and safe environment to carry out any repairs.

.....

Model No:

Serial No:

Retailer:

Date of purchase:

.....

**For service under guarantee simply telephone the appropriate number below**



**UK Mainland & Northern Ireland** 0333 207 9920 or [customerservice@support.grundig.co.uk](mailto:customerservice@support.grundig.co.uk)

**Republic of Ireland:** 01 691 0203

**Register your appliance at:** *grundig.co.uk/support/register*

Before requesting service please check the troubleshooting guide in the Operating Instructions as a charge may be levied where no fault is found even though your product may still be under guarantee.

**Service once the manufacturers guarantee has expired**

If you have purchased an extended guarantee please refer to the instructions contained within the extended guarantee agreement document, otherwise please call the appropriate number above where service can be obtained at a charge.

Should you experience any difficulty in obtaining service contact the Grundig Customer Helpline on Tel: 0333 207 9920 or e-mail: [customerservice@support.grundig.co.uk](mailto:customerservice@support.grundig.co.uk)

.....  
This guarantee is provided by Beko plc. Beko House, 1 Greenhill Crescent, Watford, Herts, WD18 8QU. Beko plc is registered in England and Wales with company registration number 02415578.





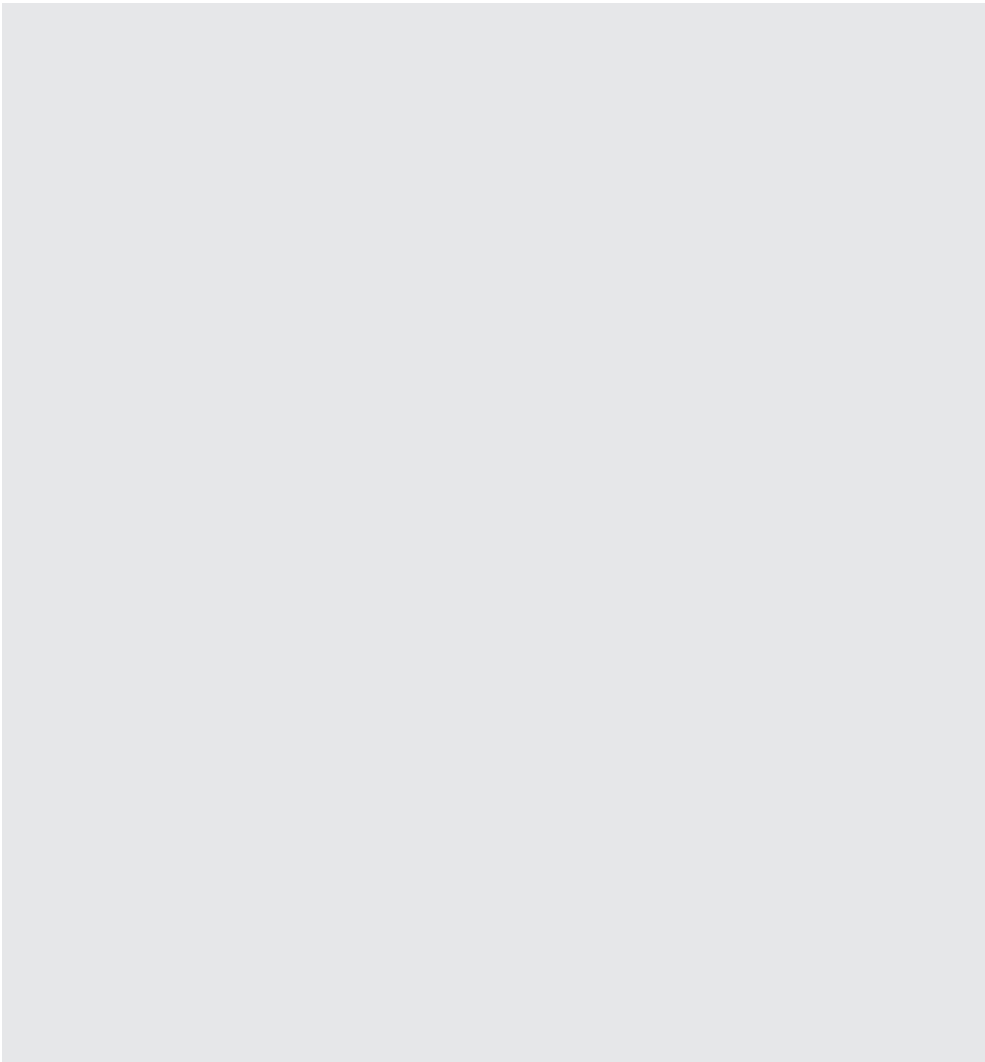

**GRUNDIG**

[www.grundig.com](http://www.grundig.com)